

CERTIFIED RECORD OF LAND CORNER MONUMENTATION

P-9

History of original corner establishment:

Corner established in 1882 by George Pershin under General Land Office Contract No. 430

Surveyor General Records states:

Set basalt stone 16" x 10" x 8" for 1/4 corner from which:

- A Pine 5 in. dia. bears N 66 E, 32 lks. dist.
- A Pine 8 in. dia. bears S 67 W, 71 lks. dist.

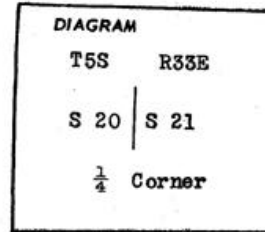

Description of corner evidence found:

Found stone call size loose on ground near fence corner.

Found SW BT, scribes visible.

No evidence of other BT found.

Description of monument and accessories established to perpetuate the original location of this corner

At record bearing and distance from SW BT I set 2 1/2" x 30" iron pipe with brass cap marked as shown 21" in ground, from which:

Original BT:

A 18" P. Pine bears S 67 W, 46.9 ft. scribes visible.

New BT:

A 26" P. Pine bears N 34 E, 81.4 ft. marked T5S R33E 1/4 S21 BT.

Set steel fence post 2" West.

Raised mound of stone.

Buried stone North and alongside pipe.

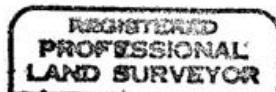
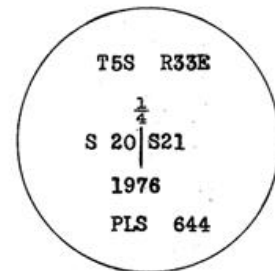

Duane J. Griffith

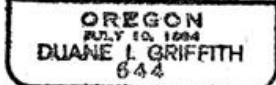

Brass washer nailed to BT blazes.
Used steel tape and magnetic compass with 19° 30' East declination.
Measured to center of BTs.

Office of County of

State of, I hereby certify that the within instrument was filed in this office for record on the day of

..... by (DEPUTY)

(COUNTY OFFICIAL)

Noted in '90'