

USDA-FOREST SERVICE

Index  
File No. P-5  
T 55 R. 33E  
Merid. Willamette

CORNER RECORD (SEARCH)

(Ref. FSM 7151.4)

Tract or Survey No. \_\_\_\_\_ Cor. No. 1/4  
R.D. Ukiah County Umatilla  
N.F. Umatilla State Oregon

CORNER DIAGRAM

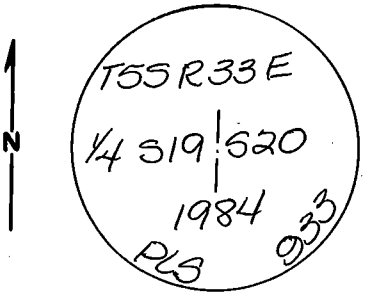

DESCRIBE CORNER MONUMENT FOUND

None

DESCRIBE BEARING TREES OR OTHER OFFICIAL ACCESSORIES FOUND

None

PHOTO IDENTIFICATION DATA

Photo No. \_\_\_\_\_  
Filed At. \_\_\_\_\_  
Object Ident. \_\_\_\_\_  
Ident. By \_\_\_\_\_  
*Signature*

PLANE COORDINATE POSITION DATA

State \_\_\_\_\_ Zone \_\_\_\_\_  
X \_\_\_\_\_  
Y \_\_\_\_\_  
Estab. By \_\_\_\_\_  
*Agency*

DESCRIBE CORNER LOCATION RELATIVE TO NEAR-BY FEATURES, ALSO HOW TO REACH CORNER

Fence 20' E Huns N-S

From Hiaway Springs take Rd 5450 South 1.5 mi. to road on right, take road 0.7 mi. to fork, take right fork 0.5 mi., corner is West 0.2 mi.

*Signature*  
David H. Klein

*Title*  
PLS 933

*Division*

*Headquarters*

*Date*  
7/16/84

7100-52-(3/68)

CORNER RECORD (PERPETUATION)

MONUMENT: DESCRIBE NEW MONUMENT SET, OR WORK DONE TO PRESERVE EXISTING MONUMENT

Set a 2 1/2" dia. Brass Cap on a 2 1/2" galvanized pipe set 15" in the ground.

Built a stone mound around the Brass Cap.

ACCESSORIES : DESCRIBE NEW BT'S WITNESS OBJECTS ETC. ESTABLISHED, OR WORK DONE TO PRESERVE EXISTING EVIDENCE

A 12" Ponderosa Pine bears N48°E, 15.9 feet

A 8" Ponderosa Pine bears N39°W, 25.1 feet

Steel fence post with signs #54-4 by the corner

Trees have signs #54-3 & 54-4 and Brass washers

Work Done By R. Panches Title Party Chief Date 7/5/84 State Registration No. or Agency

Certified Cor. Record Prepared?  Yes  No Filed At: Umatilla County Surveyor Date 7-24-84

REMARKS

Index File No. P-5 T. 55 R. 33E M. W. Tract or Surv. No. Cor. 44

USDA-FOREST SERVICE

Index

File No. P-5

CORNER RECORD (SEARCH)

(Ref. FSM 7151.4)

Tract or

Survey No. \_\_\_\_\_

Cor.

No. \_\_\_\_\_

T 55 R. 33E

R.D. UKIAH

County UMATILLA

Merid. WILL

N.F. UMATILLA

State OREGON

CORNER DIAGRAM

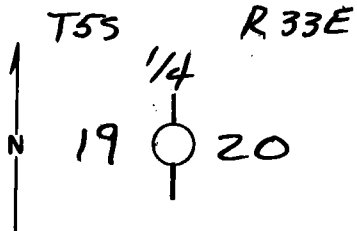

DESCRIBE CORNER MONUMENT FOUND

NONE

DESCRIBE BEARING TREES OR OTHER OFFICIAL ACCESSORIES FOUND

NONE SET - SEARCH AREA IN VICINITY OF N-S FENCE.

PHOTO IDENTIFICATION DATA

Photo No. \_\_\_\_\_

Filed At. \_\_\_\_\_

Object Ident. \_\_\_\_\_

Ident. By \_\_\_\_\_

Signature

PLANE COORDINATE POSITION DATA

State \_\_\_\_\_ Zone \_\_\_\_\_

X \_\_\_\_\_

Y \_\_\_\_\_

Estab. By \_\_\_\_\_

Agency

Signature

Title

Division

Headquarters

Date

7100-52 (3. 68)

Dennis L. GAYLORD

PLS 1636

8-27-82

**CORNER RECORD (PERPETUATION)**

**MONUMENT: DESCRIBE NEW MONUMENT SET, OR WORK DONE TO PRESERVE EXISTING MONUMENT**

**ACCESSORIES : DESCRIBE NEW BT'S WITNESS OBJECTS ETC. ESTABLISHED, OR WORK DONE TO PRESERVE EXISTING EVIDENCE**

Work Done By \_\_\_\_\_ Title \_\_\_\_\_ Date \_\_\_\_\_ State Registration No. \_\_\_\_\_  
or Agency \_\_\_\_\_  
Certified Cor. Record Prepared ? Yes No Filed At: \_\_\_\_\_ Date \_\_\_\_\_

**REMARKS**

Index File No. T. R. M. Tract or Surv. No. Cor.

Index File No. P-5

T 5S R. 33E

Merid. Willamette

**CORNER RECORD (SEARCH)**

(Ref. FSM 7151.4)

R.D. Ukiah

N.F. Umatilla

County Umatilla

State Oregon

Tract or Survey No. 5-91

Cor. No. P-5

**CORNER DIAGRAM**

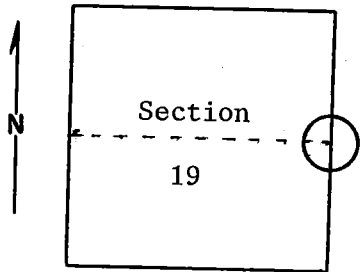

**DESCRIBE CORNER MONUMENT FOUND**

None.

**DESCRIBE BEARING TREES OR OTHER OFFICIAL ACCESSORIES FOUND**

North-south fence line in open field. No evidence of 1/4 corner.

**DESCRIBE CORNER LOCATION RELATIVE TO NEAR-BY FEATURES, ALSO HOW TO REACH CORNER**

**PHOTO IDENTIFICATION DATA**

Photo No. \_\_\_\_\_

Filed At. \_\_\_\_\_

Object Ident. \_\_\_\_\_

Ident. By \_\_\_\_\_

*Signature*

**PLANE COORDINATE POSITION DATA**

State \_\_\_\_\_ Zone \_\_\_\_\_

X \_\_\_\_\_

Y \_\_\_\_\_

Estab. By \_\_\_\_\_

*Agency*

Signature

B. Moore

Title

Engineering Technician

Division

Headquarters

S, O,

Date

December 10, 1974

100-52-(3/68)

**CORNER RECORD (PERPETUATION)**

**MONUMENT: DESCRIBE NEW MONUMENT SET, OR WORK DONE TO PRESERVE EXISTING MONUMENT**

**ACCESSORIES : DESCRIBE NEW BT's WITNESS OBJECTS ETC. ESTABLISHED, OR WORK DONE TO PRESERVE EXISTING EVIDENCE**

Work Done By \_\_\_\_\_ Title \_\_\_\_\_ Date \_\_\_\_\_ State Registration No. \_\_\_\_\_  
or Agency \_\_\_\_\_  
Certified Cor. Record Prepared ? Yes No Filed At: \_\_\_\_\_ Date \_\_\_\_\_

**REMARKS**

Index & File No. P-5 T. R. M. Tract or Surv. No. Cor. \_\_\_\_\_