

USDA-FOREST SERVICE

Index File No. N-7

CORNER RECORD (SEARCH)

(Ref. FSM 7151.4)

Tract or Survey No. _____ Cor. No. 1/4

T 5S R. 33 E

R.D. Waltham County Umatilla

Merid. Willamette

N.F. Umatilla State Oregon

CORNER DIAGRAM

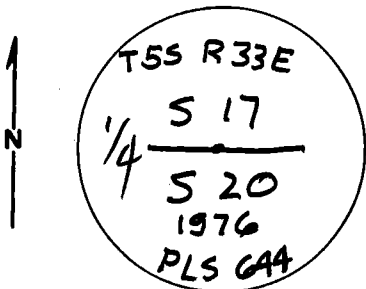

DESCRIBE CORNER MONUMENT FOUND

Found a 2 1/2" Brass Cap on a 2 1/2" Galvanized pipe stamped as shown, 6" above ground

DESCRIBE BEARING TREES OR OTHER OFFICIAL ACCESSORIES FOUND

Found bearing trees in NW and SE quadrants

PHOTO IDENTIFICATION DATA

Photo No. _____
 Filed At. _____
 Object Ident. _____
 Ident. By _____
Signature

PLANE COORDINATE POSITION DATA

State _____ Zone _____
 X _____
 Y _____
 Estab. By _____
Agency

DESCRIBE CORNER LOCATION RELATIVE TO NEAR-BY FEATURES, ALSO HOW TO REACH CORNER

From Hiway Springs take Road 5450 South 1.3 mile to Fence walk west along fence 1100 feet to corner

Signature David H. Keller

Title PLS 933

Division _____

Headquarters _____

Date 7-25-84

7100-52-(3/68)

CORNER RECORD (PERPETUATION)

MONUMENT: DESCRIBE NEW MONUMENT SET, OR WORK DONE TO PRESERVE EXISTING MONUMENT

None

ACCESSORIES: DESCRIBE NEW BT'S WITNESS OBJECTS ETC. ESTABLISHED, OR WORK DONE TO PRESERVE EXISTING EVIDENCE

None

Work Done By D Klein Title _____ Date 7-25-04 State Registration No. _____
or Agency _____

Certified Cor. Record Prepared? Yes No _____ Filed At: _____ Date _____

REMARKS

Index File No. N-7 T. 55 R. 33 E M. Willamette Tract or Surv. No.

Cor. $\frac{1}{4}$

Index
File No. N-7

CORNER RECORD (SEARCH)
(Ref. FPM 7151.4)

Tract or
Survey No. _____
Cor. No. N-7

T 55 R. 33E

R.D. WILKIN County UMATILLA

Merid. _____

N.F. UMATILLA State OREGON

CORNER DIAGRAM

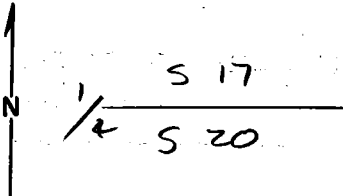

DESCRIBE CORNER MONUMENT FOUND

NONE

DESCRIBE BEARING TREES OR OTHER OFFICIAL ACCESSORIES FOUND

FND 26" D PINE, SCRIBES VISIBLE

PHOTO IDENTIFICATION DATA

Photo No. _____
Filed At. _____
Object Ident. _____
Ident. By _____

Signature

DESCRIBE CORNER LOCATION RELATIVE TO NEAR-BY FEATURES, ALSO HOW TO REACH CORNER

PLANE COORDINATE POSITION DATA

State _____ Zone _____
X _____
Y _____
Estab. By _____

Agency

Signature

D. D. [Signature]

Title

SUR.

Division

Headquarters

Date

10/78

7100-52-(3/68)

CORNER RECORD (PERPETUATION)

MONUMENT: DESCRIBE NEW MONUMENT SET, OR WORK DONE TO PRESERVE EXISTING MONUMENT

SET 2 1/2" X 30" IRON PIPE WITH BRASS CAP

9

ACCESSORIES : DESCRIBE NEW BT'S WITNESS OBJECTS ETC. ESTABLISHED, OR WORK DONE TO PRESERVE EXISTING EVIDENCE

ORIG. BT

A 20" P. PINE, N 86 W, 21.8 FT SCRIBES VISIBLE

NEW BT'S

A 10" P. PINE, N 89 E, 31.5 FT

A 10" P. PINE, S 4 E, 29.6 FT

10

Work Done By D I GRIFFITH Title SURVEYOR Date 10/76 State Registration No. ORE. PLS. 694 or Agency

Certified Cor. Record Prepared? Yes No Filed At: AMATILLA Co. Ct. House Date 1/77

11

REMARKS

12

Index File No. 4 T. 55 R. 33E W. M.

Tract or Surv. No.

Cor.

N-7

N-7

13