

Index
File No. J-5

CORNER RECORD (SEARCH)

(Ref. FSM 7151.4)

Tract or Survey No. 5-88

Cor. No. J-5

T 5S R. 33E

R.D. Ukiah

County Umatilla

Merid. Willamette

N.F. Umatilla

State Oregon

CORNER DIAGRAM

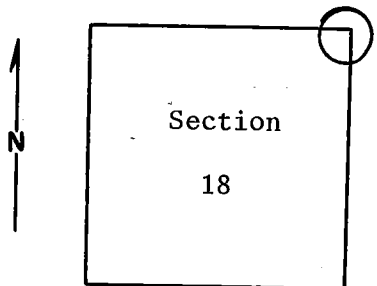

DESCRIBE CORNER MONUMENT FOUND

Material: None.

Many piles of stone in area.

DESCRIBE BEARING TREES OR OTHER OFFICIAL ACCESSORIES FOUND

None--faint evidence of old fences run north-south and east.

From a point approximately 500 feet north of approximate corner location, the fence runs north-south and appears to be on section line from there north. However, from that point south (the point 500 feet north of approximate corner), the fence runs at random and is about 60 feet east of approximate corner location. Land has been cultivated at (cont. in block 12)

PHOTO IDENTIFICATION DATA

Photo No. _____
Filed At. _____
Object Ident. _____
Ident. By _____
Signature _____

DESCRIBE CORNER LOCATION RELATIVE TO NEAR-BY FEATURES, ALSO HOW TO REACH CORNER

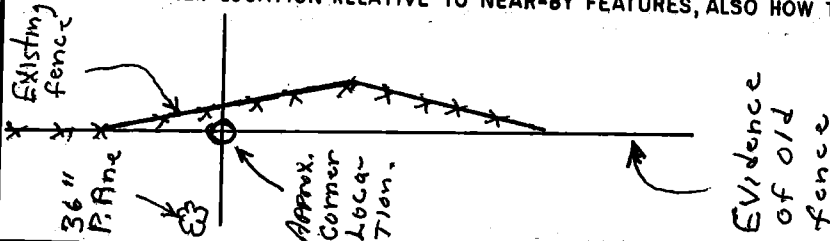

PLANE COORDINATE POSITION DATA

State _____ Zone _____
X _____
Y _____
Estab. By _____
Agency _____

Signature
T. Hollamon

Title
Engineering Technician

Division
Headquarters
S. O.

Date
December 9, 1974

CORNER RECORD (PERPETUATION)

MONUMENT : DESCRIBE NEW MONUMENT SET, OR WORK DONE TO PRESERVE EXISTING MONUMENT

9

ACCESSORIES : DESCRIBE NEW BT'S WITNESS OBJECTS ETC. ESTABLISHED, OR WORK DONE TO PRESERVE EXISTING EVIDENCE

10

Work Done By _____ Title _____ Date _____ State Registration No. or Agency _____

Certified Cor. Record Prepared ? Yes No Filed At: _____ Date _____ 11

REMARKS

(Block #3, cont.)

one time in the SW quadrant from approximate corner location.

There is a p.pine 36 inches in diameter, or more, about 50 feet westerly from approximate corner location. It may have grown since survey (1882). GLO notes say "no trees." (Another tree about 300 feet away has broken off and shows to have been about 20 inches in about 60 years.)

12

Index File No. T. R. M. Tract or Surv. No. Cor. 13