

USDA-FOREST SERVICE

Index
File No. B-23

T 5S R. 33E

Merid. Willamette

CORNER RECORD (SEARCH)

(Ref. FSM 7151.4)

R.D. Ukiah County

N.F. Umatilla State

Tract or
Survey No. Umatilla

Cor. No. CN 1/16

CORNER DIAGRAM

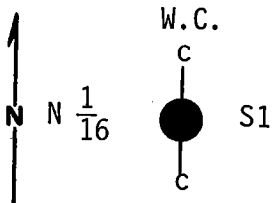

DESCRIBE CORNER MONUMENT FOUND

No corner was originally set.

DESCRIBE BEARING TREES OR OTHER OFFICIAL ACCESSORIES FOUND

None set.

PHOTO IDENTIFICATION DATA

Photo No. _____

Filed At. _____

Object Ident. _____

Ident. By _____

Signature

PLANE COORDINATE POSITION DATA

State _____ Zone _____

X _____

Y _____

Estab. By _____

Signature

Howard [Signature]

DESCRIBE CORNER LOCATION RELATIVE TO NEAR-BY FEATURES, ALSO HOW TO REACH CORNER

Corner falls in north shoulder of State Hwy. No. 244. Take Hwy No. 244 west to 4 wood post with location tags for CN 1/16 cor.

Title

Division
ORLS

Headquarters
1294

Date
9/77

7100-52-(3/68)

CORNER RECORD (PERPETUATION)

MONUMENT: DESCRIBE NEW MONUMENT SET, OR WORK DONE TO PRESERVE EXISTING MONUMENT

At surveyed point set 40 penny spike. Corner falls in north shoulder of State Hwy. No. 244, therefore set 2½"x30" galvanized pipe on N-S C 1/4 line S1, 50 ft. North of CN 1/16 corner for witness corner stamped:

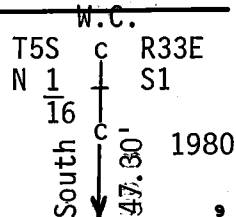

Set pipe 22" in ground with mound of stone to cap.

ACCESSORIES: DESCRIBE NEW BT'S, WITNESS OBJECTS ETC. ESTABLISHED, OR WORK DONE TO PRESERVE EXISTING EVIDENCE
 Bearing Trees to true CN 1/16 corner position. A Lodge Pole Pine 6" dia. OR PLS 1294 bears S90°E, 120.1 ft., scribed CN 1/16 S1 BT. A Lodge Pole Pine 7" dia. bears N00°30'E, 62.3 ft., scribed CN 1/16 S1 BT. Attached 54-3 and 54-4 signs to both BTs. Attached brass washer stamped LS1294 to foot blaze of both BTs. Painted blazes and 6" band around both BTs. red. Attached 54-2, 54-4 and 54-9 signs to metal post 4 ft. north of witness corner.

10

Work Done By R.C. Orton Title Party Chief Date 6/13/80 State Registration No. _____ or Agency _____

Certified Cor. Record Prepared? Yes No Filed At: _____ Date _____ 11

Witnesses:

R. Orton
G. Orton
D. Allen

REMARKS

Index File No. B-23 T. 5S R. 33E M. _____ Tract or Surv. No. _____ U.S. G.P.O. 1977-725-576/586 13