

Index File No. V-9

CORNER RECORD (SEARCH)
(Ref. FSM 7151.4)

Tract or Survey No. _____ Cor. No. _____

T 55 R. 32 E
Merid. WILLAMETTE

R.D. UKIAH County UMATILLA
N.F. UMATILLA State OREGON

CORNER DIAGRAM

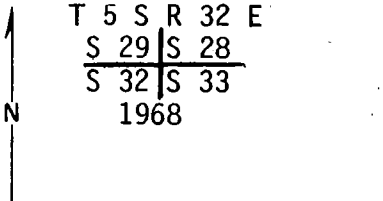

DESCRIBE CORNER MONUMENT FOUND

Found an iron pipe, firmly set, 2½ ins. diam., in a mound of stone, 2½ ft. base, to top, with brass cap mkd.

U.S. Dept. of Interior
Bureau of Land Management
T 5 S R 32 E
S 29 S 28
S 32 S 33
1968

DESCRIBE BEARING TREES OR OTHER OFFICIAL ACCESSORIES FOUND

Original BT's:

- A Ponderosa Pine stump, 16 ins. diam., bears N. 62° E., 59 lks. dist., with scribe marks 5S R32E S28 BT visible on opened blaze.
- A root hole, bears S. 66° E., 92 lks. dist., with scribing visible on downed Fir log alongside.
- A Fir stump, 18 ins. diam., bears N. 24° W., 84 lks. dist., with healed blaze.

BLM BT's (1968):

- A Larch, 10 ins. diam., bears N. 48° E., 40 lks. dist., with well-healed blaze.
- A Larch, 8 ins. diam., bears S. 25° E., 46 lks. dist., scribing visible on partially healed blaze.
- A Larch, 20 ins. diam., bears S. 24° W., 54 lks. dist., with well-healed single blaze.

PHOTO IDENTIFICATION DATA

Photo No. 280-238
Filed At. UMATILLA NATL FOR.
Object Ident. DIRECT.
Ident. By A. Knight
Signature

PLANE COORDINATE POSITION DATA

State _____ Zone _____
X _____
Y _____
Estab. By _____

(Contd. in Item 12 on reverse)

Signature
Agency

Title LS 1099 Division _____ Headquarters _____ Date 9-17-84 FS-7100-52 (3/68)

CORNER RECORD (PERPETUATION)

MONUMENT: DESCRIBE NEW MONUMENT SET, OR WORK DONE TO PRESERVE EXISTING MONUMENT

None

ACCESSORIES: DESCRIBE NEW BT $\frac{1}{2}$ WITNESS OBJECTS ETC. ESTABLISHED, OR WORK DONE TO PRESERVE EXISTING EVIDENCE

None

Work Done By: Gary Langlitz Title LS 1099 Date 8-84 State Registration No. or Agency

Certified Cor. Record Prepared? Yes No Filed At: Date

(BLM BT's Continued) REMARKS
A Larch, 14 ins. diam., bears N. 79° W., 43 lks. dist., with well-healed single blaze.

Index File No. V-9 T. 5S R. 32E M. WILLAMETTE Tract or Surv. No. Cor.

Index
File No. V-9

CORNER RECORD (SEARCH)

(Ref. FSM 7151.4)

Tract or Survey No. 5-97 Cor. No. V-9

T 5S R. 32E

R.D. Ukiah County Umatilla

Merid. Willamette

N.F. Umatilla State Oregon

CORNER DIAGRAM

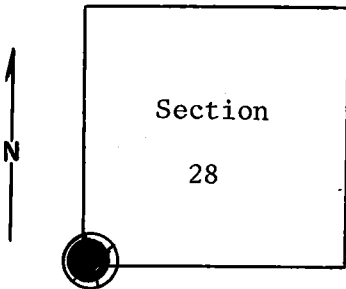

DESCRIBE CORNER MONUMENT FOUND

Material: Stone mound. ● *See Mon. file*

DESCRIBE BEARING TREES OR OTHER OFFICIAL ACCESSORIES FOUND

A 20-inch pine stump (4 feet high) bears N62°E approximately 35 feet from stone mound. Scribed on SW face, "S, R32E, S28." FS B.T. poster on it.

A 12-inch tamarack bears N48°E from mound approximately 25 feet. Scribed on SW face. BLM B.T. poster.

A burned out 20-inch fir snag with FS B.T. poster bears N24°W approximately 60 feet. No scribing visible. (cont. in block 12)

DESCRIBE CORNER LOCATION RELATIVE TO NEAR-BY FEATURES, ALSO HOW TO REACH CORNER

PHOTO IDENTIFICATION DATA

Photo No. _____
Filed At. _____
Object Ident. _____
Ident. By _____
Signature

PLANE COORDINATE POSITION DATA

State _____ Zone _____
X _____
Y _____
Estob. By _____
Agency

Signature
B. Moore
Title
Engineering Technician
Division
S, O.

Headquarters
S, O.
Date
December 15, 1974
7100-52-(3/68)

2

12

4

5

CORNER RECORD (PERPETUATION)

MONUMENT: DESCRIBE NEW MONUMENT SET, OR WORK DONE TO PRESERVE EXISTING MONUMENT

9

ACCESSORIES : DESCRIBE NEW BT'S WITNESS OBJECTS ETC. ESTABLISHED, OR WORK DONE TO PRESERVE EXISTING EVIDENCE

10

Work Done By _____ Title _____ Date _____ State Registration No. _____ or Agency _____

Certified Cor. Record Prepared ? Yes No Filed At: _____ Date _____ 11

REMARKS

(Block #3, cont.) (Would be burned out.)
A 30-inch diameter fir log bears S66°E approximately 60 feet. Scribing is visible underneath butt end. Put B.T. poster on it.
A 13-inch live tamarack with BLM B.T. poster bears N80°W approximately 25 feet.
A 20-inch live tamarack with BLM B.T. poster & scribing on NE face bears S28°W approx. 30'.
8-inch tamarack bears S20°E (30 feet). BLM B.T. poster.

12

Index File No. T. R. M. Tract or Surv. No. Cor. 13