

USDA-FOREST SERVICE

Index Q-5

File No. 55-31E

T 55 R 31E

Merid. Willamette

CORNER RECORD (SEARCH)

(Ref. FSM 7151.4)

Tract or Survey No. Sec 19

Cor. No. S 1/16

Ukiah

County

Umatilla

R.D.

Umatilla

State

Oregon

N.F.

CORNER DIAGRAM

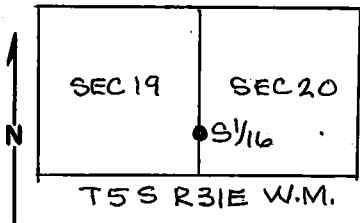

DESCRIBE CORNER MONUMENT FOUND

None

DESCRIBE BEARING TREES OR OTHER OFFICIAL ACCESSORIES FOUND

None

PHOTO IDENTIFICATION DATA

Photo No. _____

Filed At. _____

Object Ident. _____

Ident. By _____

Signature

PLANE COORDINATE POSITION DATA

State _____ Zone _____

X _____

Y _____

Estab. By _____

Agency

DESCRIBE CORNER LOCATION RELATIVE TO NEAR-BY FEATURES, ALSO HOW TO REACH CORNER

From location poster on South side of road corner is 850' South.

Signature
William R. Wells

Title
PLS 1106

Division

Headquarters

Date
8/13/79

7100-52-(3/68)

CORNER RECORD (PERPETUATION)

MONUMENT: DESCRIBE NEW MONUMENT SET, OR WORK DONE TO PRESERVE EXISTING MONUMENT

Set a 2" x 30" galvanized iron pipe with a brass cap 5"
 in ground with a mound of stone to the cap, marked:
 Set steel fence posts North and East of corner on
 property line and attached signs 54-2 and 54-9.

T55 R31E
 S 1/16
 S19 S20
 1979
 PLS 1106

9

ACCESSORIES: DESCRIBE NEW BT'S WITNESS OBJECTS ETC. ESTABLISHED, OR WORK DONE TO PRESERVE EXISTING EVIDENCE

A 13½" bull pine bears N80°E 75.6 ft. to center, marked S 1/16 S 20 BT.
 A 8½" bull pine bears S 70½°W 29.2 ft. to center, marked S 1/16 S 19 BT.
 BT's have a lower blaze scribed BT with a brass washer stamped PLS 1106 nailed flush.
 Attached signs 54-3 and 54-4 and painted red ring around BT's.

10

Work Done By William R. Wells Title PLS Date 8/13/79 State Registration No. or Agency 1106

Certified Cor. Record Prepared? Yes No Filed At: Umatilla County Surveyor's Office Date _____

11

REMARKS

Witnesses: Greg Flowers L.S.I.T.
 Brent Reynolds