

OREGON CORNER RESTORATION FORM

COUNTY: Umatilla DATE: 07/02/02

CORNER DESIGNATION: N-19, The South Quarter Corner of Section 14, T5S, R31E., W.M..

PREVIOUS RENEWALS/SURVEYS ETC.: Corner established by George S. Pershin, under Contract No. 373, dated Sept. 17, 1880. Notes state: Set basalt stone, 14 x 10 x 5, on level, in mound of stone for 1/4 Sec. Cor.

MONUMENT AND ACCESSORIES FOUND:

Found a 16" x 10" x 6" stone marked 1/4 laying flat in ground 6", in a boggy grass bottomland. Dug down below stone and started to hit other small stones (part of original mound). It appears that the mound of stone has sunk below the ground due to the wetness of the corner area.

MONUMENT MARKING DETAIL:

T5S R31E
1/4 S14
S23
2002
PLS 1106

MONUMENT SET:

At position of found corner stone, set a 2 1/2" brass cap on a 1 1/4" x 30" galvanized iron pipe with top of cap 2" above ground level. Monument is marked as shown in "Monument Marking Detail". Buried original stone on North side of brass cap monument and surrounded with large stones and earth.

New Accessories:

A 40" ponderosa pine scribed "1/4 S23 BT" bears S 72 1/2° W, 167.9'.

A 5/8" x 30" iron rebar with cap 4" above ground level, with a yellow plastic cap stamped "OR PLS 1106, WA PLS 17372" bears N 54° W 110.9'. This accessory is located at a fence angle point in a crooked North-South fence.

From the re-monumented corner point:

The reestablished SE Corner of Section 14 bears S 89°34'22" W 2640.37'.

The reestablished SW Corner of Section 14 bears N 89°57'44" W 2665.85'.

Attached bearing object sign to new bearing tree and to wood fence post 1.0 feet beyond 5/8" iron rebar.

LOCATION AND COMMENTS: Corner is located in a wet meadow East of a crooked North-South fence.

STATE PLANE COORDINATE, OREGON NORTH ZONE, NAD 83/91, INT. FOOT:

N = 536229.95
E = 8606869.76

FIRM: William R. Wells, PLS
P.O. Box 1696
Pendleton, OR 97801

COMPASS DECLINATION: 18° East

Witnesses: Jason Wells, LSIT
Mark Hammersla
\\SS31N19

Surveyor's Seal

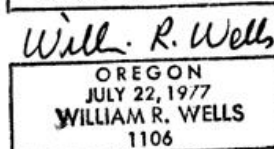
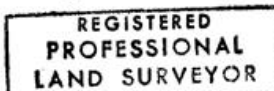

renews 6-30-04

RECEIVED BY

Umatilla County Surveyor
Date 10-02
Rec'd By KK
No. 02-218-B