

**OREGON CORNER RESTORATION FORM**

COUNTY: Umatilla. DATE: 06/15/10

CORNER DESIGNATION: G-17, The West 1/4 Corner of Section 11, Township 5 South, Range 31 East, W.M.

PREVIOUS RENEWALS/SURVEYS ETC: Corner originally established by George S. Pershin, U.S. Deputy Surveyor, under Contract No. 373, dated September 17, 1880. Notes state: Set basalt stone 12x8x7 on South slope in mound of stone for 1/4 section corner.

MONUMENT AND ACCESSORIES FOUND: Found 12x6x4 inch set basalt stone marked 1/4 on West face.

**MONUMENT MARKING DETAIL:**

T5S R31E  
1/4  
S10|S11  
2010  
PLS 1106

MONUMENT SET: At position of found stone set a 2 3/8" brass cap on 1 1/4"x30" galvanized iron pipe with the cap 1" above ground level in small mound of stone. Buried the original stone on the South side of the monument with marks visible. Cap is marked as shown in "Monument Marking Detail."

**New accessories:**

A 5/8"x24" iron rebar with 1 1/4" red plastic cap stamped "OR PLS 1106 WA PLS 17372", 3" above ground level bears N 37° E, 37.7 feet.

A 5/8"x24" iron rebar with 1 1/4" red plastic cap stamped "OR PLS 1106 WA PLS 17372", 3" above ground level bears S 74° E, 29.6 feet.

A 5/8"x24" iron rebar with 1 1/4" red plastic cap stamped "OR PLS 1106 WA PLS 17372", 3" above ground level bears S 45° W, 29.9 feet.

A 5/8"x24" iron rebar with 1 1/4" red plastic cap stamped "OR PLS 1106 WA PLS 17372", 3" above ground level bears N 44° W, 29.4 feet.

Attached bearing object signs to all rebar accessories. Attached Witness sign to brass cap monument.

LOCATION AND COMMENTS: Corner is located on a South slope approximately 150 feet North of a dry creek bed in pasture land.

FIRM: Wells Surveying  
P.O. Box 1696  
Pendleton, OR 97801

COMPASS DECLINATION: 18° East

Surveyor's Seal

Witnesses: Jason Wells, LSIT  
Dean Roy

VSS31G17

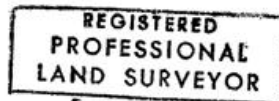

*Will. R. Wells*

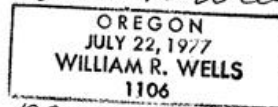

*renews 6-30-12*