

Index File No. A-1  
 T 5 S. R. 31 E.  
 Merid. Willamette

**CORNER RECORD (SEARCH)**

(Ref. FSM 7151.4)

Tract or Survey No. \_\_\_\_\_ Cor. No. \_\_\_\_\_

R.D. Ukiah County Umatilla  
 N.F. Umatilla State Oregon

**CORNER DIAGRAM**

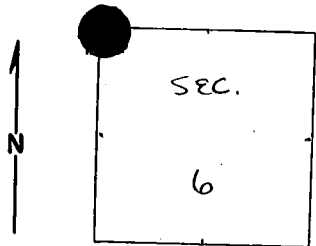

**DESCRIBE CORNER MONUMENT FOUND**

Material: Stone mound

Markings: None visible (GLO notes, do not mention markings)

*Monumented*

**DESCRIBE BEARING TREES OR OTHER OFFICIAL ACCESSORIES FOUND**

North-South fence approximately 20 feet west of the mound. The SW and NW BT's still stand. The SE and NE BT's have been cut. The stumps remain. Visible scribing on all four. Mound is 20 feet north of middle of stream bed.

**PHOTO IDENTIFICATION DATA**

Photo No. \_\_\_\_\_  
 Filed At. \_\_\_\_\_  
 Object Ident. \_\_\_\_\_  
 Ident. By \_\_\_\_\_  
*Signature*

**PLANE COORDINATE POSITION DATA**

State \_\_\_\_\_ Zone \_\_\_\_\_  
 X \_\_\_\_\_  
 Y \_\_\_\_\_  
 Estab. By \_\_\_\_\_  
*Agency*

**DESCRIBE CORNER LOCATION RELATIVE TO NEAR-BY FEATURES, ALSO HOW TO REACH CORNER**

There is a primitive road on Hogback N.W. (See Sugarbowl Creek 7.5 minute quad. map)

Signature T. Hollamon Title Engr, Tech, Division \_\_\_\_\_ Headquarters \_\_\_\_\_ Date 4-21-76

**CORNER RECORD (PERPETUATION)**

**MONUMENT: DESCRIBE NEW MONUMENT SET, OR WORK DONE TO PRESERVE EXISTING MONUMENT**

9

**ACCESSORIES : DESCRIBE NEW BT'S WITNESS OBJECTS ETC. ESTABLISHED, OR WORK DONE TO PRESERVE EXISTING EVIDENCE**

I placed a blank BT tag on each of the BT's and BT stumps.

10

Work Done By \_\_\_\_\_ Title \_\_\_\_\_ Date \_\_\_\_\_ State Registration No. or Agency \_\_\_\_\_

Certified Cor. Record Prepared ? Yes No Filed At: \_\_\_\_\_ Date \_\_\_\_\_ 11

REMARKS

12

Index File No. T. R. M. Tract or Surv. No. Cor. 13