

Index File No. N-23
 T 5 S. R. 30 E.
 Merid. Willamette

CORNER RECORD (SEARCH)
 (Ref. FSM 7151.4)

Tract or Survey No. _____
 Cor. No. _____

R.D. Ukiah County Umatilla
 N.F. Umatilla State Oregon

CORNER DIAGRAM

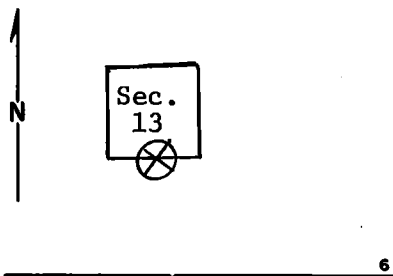

DESCRIBE CORNER MONUMENT FOUND

Stone mound; mound 4' diam., 10" deep; 10" above ground; in fair condition.

Larger center stone appears to have old marking on north face.

DESCRIBE BEARING TREES OR OTHER OFFICIAL ACCESSORIES FOUND

A location poster, dated 1940, on a 7" ponderosa pine bears S. 70° W., approx. 35 ft. According to original GLO notes, no B.T.'s were made. (Location in edge of 200' by 300' opening. No older trees in area.

(cont. in Block #12)

PHOTO IDENTIFICATION DATA

Photo No. _____
 Filed At. _____
 Object Ident. _____
 Ident. By _____
Signature

PLANE COORDINATE POSITION DATA

State _____ Zone _____
 X _____
 Y _____
 Estab. By _____
Agency

DESCRIBE CORNER LOCATION RELATIVE TO NEAR-BY FEATURES, ALSO HOW TO REACH CORNER

Signature	Title	Division	Headquarters	Date	7100-52-(3/68)
T, Hollamon	Eng, Tech,		S.O.	4/19/74	

CORNER RECORD (PERPETUATION)

MONUMENT: DESCRIBE NEW MONUMENT SET, OR WORK DONE TO PRESERVE EXISTING MONUMENT

ACCESSORIES : DESCRIBE NEW BT'S WITNESS OBJECTS ETC. ESTABLISHED, OR WORK DONE TO PRESERVE EXISTING EVIDENCE

Work Done By _____ Title _____ Date _____ State Registration No. _____
or Agency _____
Certified Cor. Record Prepared ? Yes No Filed At: _____ Date _____

(Block 3 cont.)

REMARKS

There is a location poster on a 14" ponderosa pine approx. 1,500' east.
Tree is line blazed (X) on east and west sides. Tree grows at south
edge of primitive road. (See Sugarbowl Creek quadrangle map.)

Index File No. T. R. M. Tract or Surv. No. Cor.