

Index
 File No. J-3
 T 5S R. 30E
 Merid. W.M.

CORNER RECORD (SEARCH)
 (Ref. FSM 7151.4)
 R.D. Ukiah County _____
 N.F. Umatilla State Oregon

Tract or Survey No. _____
 Cor. No. _____

CORNER DIAGRAM

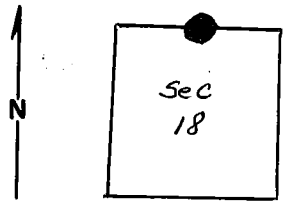

DESCRIBE CORNER MONUMENT FOUND

Found a stone 15x9x7 marked number 4. Stone above ground, condition fair.

Monumented By BLM in 1978

DESCRIBE BEARING TREES OR OTHER OFFICIAL ACCESSORIES FOUND

Juniper about 14" DBH bearing S 55° E, 124 lks has died. It has pretty good markings. A ponderosa 18" DBH bearing N 70° E, 111 lks from stone, am sure is other bearing tree. It has scribing completely grown over and has very little scar left.

Stone has been broken into. The smaller piece has 4 on it.

DESCRIBE CORNER LOCATION RELATIVE TO NEAR-BY FEATURES, ALSO HOW TO REACH CORNER

PHOTO IDENTIFICATION DATA

Photo No. _____
 Filed At. _____
 Object Ident. _____
 Ident. By _____

Signature

PLANE COORDINATE POSITION DATA

State _____ Zone _____
 X _____
 Y _____
 Estab. By _____

Agency

Signature
M. L. Christian

Title
F. T.

Division _____

Headquarters _____

Date
5/4/76

7100-52 (3/68)

CORNER RECORD (PERPETUATION)

MONUMENT: DESCRIBE NEW MONUMENT SET, OR WORK DONE TO PRESERVE EXISTING MONUMENT

9

ACCESSORIES : DESCRIBE NEW BT'S WITNESS OBJECTS ETC. ESTABLISHED, OR WORK DONE TO PRESERVE EXISTING EVIDENCE

Painted stone red and drove a steel post about 3' distance SE of stone with two metal attention signs attached to it. Painted a 6" red band around Juniper tree and attached proper signs. Also painted a 6" red band around ponderosa and attached proper metal tags.

10

Work Done By _____ Title _____ Date _____ State Registration No. or Agency _____
Certified Cor. Record Prepared ? Yes No Filed At _____ Date _____

11

REMARKS

12

Index File No. T. R. M. Tract or Surv. No. Cor. 13