

USDA-FOREST SERVICE

Index
File No. F-7

CORNER RECORD (SEARCH)

(Ref. FSM 7151.4)

Tract or
Survey No. _____ Cor.
No. _____

T 55 R. 30E

R.D. Ukiah County Umatilla

Merid. Willamette

N.F. Umatilla State Ore.

CORNER DIAGRAM

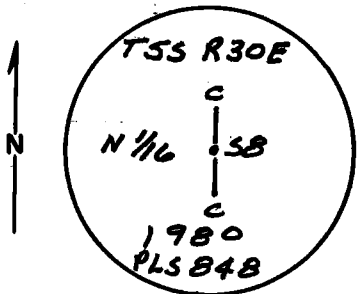

DESCRIBE CORNER MONUMENT FOUND

Corner not previouslt established.

DESCRIBE BEARING TREES OR OTHER OFFICIAL ACCESSORIES FOUND

N.A.

PHOTO IDENTIFICATION DATA

Photo No. _____

Filed At. _____

Object Ident. _____

Ident. By _____

Signature

PLANE COORDINATE POSITION DATA

State _____ Zone _____

X _____

Y _____

Estab. By _____

Agency

Signature

Title

Division

Headquarters

Date

7100-52-(3/68)

2

6

7

8

2

3

4

5

DESCRIBE CORNER LOCATION RELATIVE TO NEAR-BY FEATURES, ALSO HOW TO REACH CORNER

Corner is approx. 1/8 mi east from road 5312, at a point approx. 3/8 mi northerly along the road from Gilman ranch cabin. Corner is 1/2 mi north from Gilman ranch cabin.

CORNER RECORD (PERPETUATION)

MONUMENT: DESCRIBE NEW MONUMENT SET, OR WORK DONE TO PRESERVE EXISTING MONUMENT

Set 3"x30" galv. iron pipe with 3" brass cap stamped as shown in the diagram, set 12" in the ground & raised a mound of stone around pipe.

ACCESSORIES : DESCRIBE NEW BT'S WITNESS OBJECTS ETC. ESTABLISHED, OR WORK DONE TO PRESERVE EXISTING EVIDENCE

From which
A pipe 8" dia bears S 26 W 39.6 ft. scribed CN 1/16 S8 BT
A pine 8" dia. " S 44 E 43.0 ft. " " " "
Nailed brass washers stamped PLS 848 & bearing tree signs to each tree, painted red bands around each tree.
Set steel posts with bdry. & warning signs 5'S & 5'W from corner.
Bearing-True Grid.

Work Done By D.M. Ferguson Title Supervisor Date 9-8-80 State Registration No. PLS 848
or Agency

Certified **REGISTERED** Record Prepared? Yes No Filed At: _____ Date _____

**REGISTERED
PROFESSIONAL
LAND SURVEYOR**

REMARKS

Witnesses to above corner.
D. Herburger
L. Wyllie

OREGON
JULY 12, 1868
DOUGLAS M. FERGUSON
848

Index File No. T. R. M. Tract or Surv. No. Cor. U.S. G.P.O. 1977-725-576/586