

USDA-FOREST SERVICE

Index  
File No. Z-25  
T 4S R. 29E  
Merid. Willamette

CORNER RECORD (SEARCH)

(Ref. FSM 7151.4)

R.D. Ukiah County Morrow Tract or Survey No. S36  
N.F. Umatilla State Oregon Cor. No. SE corner

CORNER DIAGRAM

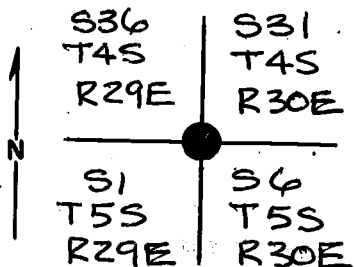

DESCRIBE CORNER MONUMENT FOUND

Found rotted remains of the original wood post buried in ground.

DESCRIBE BEARING TREES OR OTHER OFFICIAL ACCESSORIES FOUND

A dead and down tree bears N 62° E 12.5 feet  $\pm$  to stump hole with blaze rotted away.

A down and completely rotted tree bears S 34° E 13.9 feet  $\pm$ .  
A rotted stump buried under needles bears N 45° W 5.3 feet  $\pm$ .  
Old line trees run north, south, east and west from the corner.

DESCRIBE CORNER LOCATION RELATIVE TO NEAR-BY FEATURES, ALSO HOW TO REACH CORNER

Corner is located 700' south of intersection of Western Route Road and a jeep trail branching south. Location poster is on south side of road on top of cut bank.

PHOTO IDENTIFICATION DATA

Photo No. \_\_\_\_\_  
Filed At. \_\_\_\_\_  
Object Ident. \_\_\_\_\_  
Ident. By \_\_\_\_\_  
*Signature*

PLANE COORDINATE POSITION DATA

State \_\_\_\_\_ Zone \_\_\_\_\_  
X \_\_\_\_\_  
Y \_\_\_\_\_  
Estab. By \_\_\_\_\_  
*Agency*

*Signature*  
William R. Wells

Title  
PLS

Division

Headquarters

Date  
8/21/79

7100-52-(3/68)

**CORNER RECORD (PERPETUATION)**

**MONUMENT: DESCRIBE NEW MONUMENT SET, OR WORK DONE TO PRESERVE EXISTING MONUMENT**

At the corner position a 2" x 30" iron pipe with brass cap was set 29" in the ground, marked:

Set a steel fence post by the corner and attached sign 54-4.

T4S  
 R29E | R30E  
 336 | S31  
 51 | 56  
 T5S  
 PLS 1106

**ACCESSORIES: DESCRIBE NEW BT'S WITNESS OBJECTS ETC. ESTABLISHED, OR WORK DONE TO PRESERVE EXISTING EVIDENCE**

Established 4 new BT's:

A 9½" red fir bears N 8° E, 23.7 feet scribed T4S R30E S31BT,

An 8½" red fir bears S 31° E, 34.3 feet scribed T5S R30E S6BT.

A 7" tamarack bears S 54° W, 38.7 feet scribed T5S R29E S1BT.

A 9" red fir bears N 54½° W, 9.1 feet scribed T4S R29E S36BT.

New BT's have a lower blaze scribed BT with a brass washer stamped PLS 1106 nailed flush. Attached signs 54-3 and 54-4 to all BT's and painted red ring around trees above upper blaze. Location marker located on south side of road at top of cut bank 700 feet north of corner.

Work Done By William R. Wells Title PLS Date 8/21/79 State Registration No. 1106  
or Agency

Certified Cor. Record Prepared? Yes  No  Filed At: Morrow County Surveyor's Office Date 11

**REMARKS**

Witnesses: R. D. English  
B. J. Reynolds

USDA-FOREST SERVICE

Index  
File No. A-25

**CORNER RECORD (SEARCH)**

(Ref. FSM 7151.4)

Tract or Survey No. \_\_\_\_\_ Cor. No. \_\_\_\_\_

T 5S R. 29E R.D. Ukiah County \_\_\_\_\_

Merid. Willamette N.F. Umatilla State Oregon

**CORNER DIAGRAM**

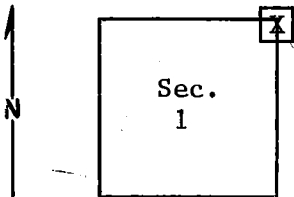

**DESCRIBE CORNER MONUMENT FOUND**

None

**DESCRIBE BEARING TREES OR OTHER OFFICIAL ACCESSORIES FOUND**

Rotted down tree - 3'x6" chunk with scribed: 6  
10" pine, blazed 4 sides. blaze lines 4 ~~cardinal~~ directions.  
*Cardinal*

**PHOTO IDENTIFICATION DATA**

Photo No. \_\_\_\_\_  
Filed At. \_\_\_\_\_  
Object Ident. \_\_\_\_\_  
Ident. By \_\_\_\_\_  
*Signature*

**DESCRIBE CORNER LOCATION RELATIVE TO NEAR-BY FEATURES, ALSO HOW TO REACH CORNER**

**PLANE COORDINATE POSITION DATA**

State \_\_\_\_\_ Zone \_\_\_\_\_  
X \_\_\_\_\_  
Y \_\_\_\_\_  
Estab. By \_\_\_\_\_  
*Agency*

Signature \_\_\_\_\_ Title \_\_\_\_\_ Division \_\_\_\_\_ Headquarters \_\_\_\_\_ Date \_\_\_\_\_ 7100-52-(3/68)

Moore, Bill Eng. Tech. 4/78

**CORNER RECORD (PERPETUATION)**

GPO 902-673

**MONUMENT : DESCRIBE NEW MONUMENT SET, OR WORK DONE TO PRESERVE EXISTING MONUMENT**

9

**ACCESSORIES : DESCRIBE NEW BT's WITNESS OBJECTS ETC. ESTABLISHED, OR WORK DONE TO PRESERVE EXISTING EVIDENCE**

10

Work Done By \_\_\_\_\_ Title \_\_\_\_\_ Date \_\_\_\_\_ State Registration No. or Agency \_\_\_\_\_

Certified Cor. Record Prepared ? Yes No Filed At \_\_\_\_\_ Date \_\_\_\_\_

REMARKS

12

Index File No. T. R. M. Tract or Surv. No. Cor. \_\_\_\_\_

13