

USDA-FOREST SERVICE

Index

File No. V 5

CORNER RECORD (SEARCH)

(Ref. FSM 7151.4)

Tract or

Survey No. \_\_\_\_\_

Cor.

No. \_\_\_\_\_

T 5N R. 38E

R.D. WALLA WALLA

County

UMATILLA

Merid. WILL

N.F. UMATILLA

State

OREGON

CORNER DIAGRAM

T5N R38E

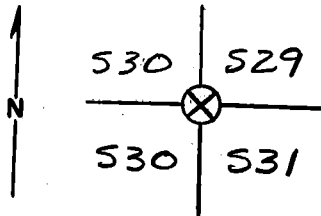

DESCRIBE CORNER MONUMENT FOUND

STONE, 22" x 15" x 6", 15" ABOVE GRND., MARKED WITH ONE NOTCH ON SOUTH & 5 NOTCHES ON THE EAST EDGES.

DESCRIBE BEARING TREES OR OTHER OFFICIAL ACCESSORIES FOUND

29" TAMARACK SNAG BEARS N81°E, 11 ft.  
 25" DOUG. FIR BEARS S20°E, 61 ft. (SLOPE)  
 29" WHITE FIR BEARS S38°W, 2 ft.  
 32½" DOUG. FIR BEARS N74°W, 62 ft. (SLOPE)

NOTE: DISTANCES TO THE DOUG. FIRS IS SLOPE DIST.

DESCRIBE CORNER LOCATION RELATIVE TO NEAR-BY FEATURES, ALSO HOW TO REACH CORNER

CORNER LIES ON EAST SLOPE OF DRAW ABOUT 3 CHAINS FROM TOP OF RIDGE TO THE EAST.

PHOTO IDENTIFICATION DATA

Photo No. \_\_\_\_\_

Filed At. \_\_\_\_\_

Object Ident. \_\_\_\_\_

Ident. By \_\_\_\_\_

Signature

PLANE COORDINATE POSITION DATA

State \_\_\_\_\_ Zone \_\_\_\_\_

X \_\_\_\_\_

Y \_\_\_\_\_

Estab. By \_\_\_\_\_

Agency

Signature

Title

Division

Headquarters

Date

15/ RAY MEVEY

FORESTER

B.C.C.

7-10-80

7100-52-(3-'68)

**CORNER RECORD (PERPETUATION)**

**MONUMENT: DESCRIBE NEW MONUMENT SET, OR WORK DONE TO PRESERVE EXISTING MONUMENT**

**ACCESSORIES : DESCRIBE NEW BT's WITNESS OBJECTS ETC. ESTABLISHED, OR WORK DONE TO PRESERVE EXISTING EVIDENCE**

Work Done By \_\_\_\_\_ Title \_\_\_\_\_ Date \_\_\_\_\_ State Registration No. \_\_\_\_\_  
or Agency \_\_\_\_\_  
Certified Cor. Record Prepared? Yes No Filed At: \_\_\_\_\_ Date \_\_\_\_\_

**REMARKS**

Index File No.

T.

R.

M.

Tract or Surv. No.

Cor.

12

13