

USDA-FOREST SERVICE

Index File No. N-9

T 5N R. 38E

Merid. WILLAMETTE

CORNER RECORD (SEARCH)

(Ref. FSM 7151.4)

R.D. WALLA WALLA County UMATILLA

N.F. UMATILLA State OREGON

Tract or Survey No. \_\_\_\_\_

Cor. No. \_\_\_\_\_

CORNER DIAGRAM

T5N R38E

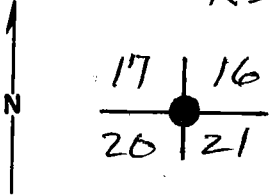

DESCRIBE CORNER MONUMENT FOUND

NONE - M.I.D.S.

DESCRIBE BEARING TREES OR OTHER OFFICIAL ACCESSORIES FOUND

34" PINE S71°42'E, 48.2 ft, PARTLY HEALED BLAZE.

44" PINE N25°28'W, 95.7 ft, PARTLY HEALED BLAZE.

PHOTO IDENTIFICATION DATA

Photo No. \_\_\_\_\_  
Filed At. \_\_\_\_\_  
Object Ident. \_\_\_\_\_  
Ident. By \_\_\_\_\_  
*Signature*

DESCRIBE CORNER LOCATION RELATIVE TO NEAR-BY FEATURES, ALSO HOW TO REACH CORNER

PLANE COORDINATE POSITION DATA

State \_\_\_\_\_ Zone \_\_\_\_\_  
X \_\_\_\_\_  
Y \_\_\_\_\_  
Estab. By \_\_\_\_\_  
*Agency*

*Signature*  
P. TOMKINS

Title

Division  
PLS 2360

Headquarters

Date  
8/94

FS-7100-52 (3/68)

CORNER RECORD (PERPETUATION)

MONUMENT: DESCRIBE NEW MONUMENT SET, OR WORK DONE TO PRESERVE EXISTING MONUMENT

ALUM CAP ON RE-BAR IN M.O.S.

9

ACCESSORIES : DESCRIBE NEW BT'S WITNESS OBJECTS ETC. ESTABLISHED, OR WORK DONE TO PRESERVE EXISTING EVIDENCE

10

Work Done By. P. TOMKINS Title \_\_\_\_\_ Date \_\_\_\_\_ State Registration No. 2360  
or Agency \_\_\_\_\_

Certified Cor. Record Prepared? Yes  No  Filed At: \_\_\_\_\_ Date \_\_\_\_\_

11

REMARKS

12

Index File No. N-9 T. 5N R. 38E M. \_\_\_\_\_ Tract or Surv. No. \_\_\_\_\_ Cor. \_\_\_\_\_

13

P

USDA-FOREST SERVICE

BLM

Index File No. N-9

CORNER RECORD (SEARCH)

(Ref. FSM 7151.4)

Tract or Survey No. \_\_\_\_\_ Cor. No. N-9

T 5N R. 38E

R.D. \_\_\_\_\_ County \_\_\_\_\_

Merid. Willamette

N.F. \_\_\_\_\_ State Oregon

CORNER DIAGRAM

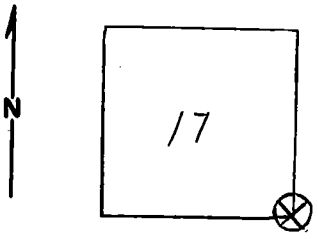

DESCRIBE CORNER MONUMENT FOUND

No stone found.  
Set a steel post and a mound of stone.

DESCRIBE BEARING TREES OR OTHER OFFICIAL ACCESSORIES FOUND

Pin a 40 inches (dead, only face remains)  
N 76° E 77 IKS.

Pin a 30 inch (now 38 inch) S 63° E 73 IKS.

Pin a 30 inch (now 38 inch) N 24° W 1 ch 45 IKS.

PHOTO IDENTIFICATION DATA

Photo No. \_\_\_\_\_

Filed At. \_\_\_\_\_

Object Ident. \_\_\_\_\_

Ident. By \_\_\_\_\_

Signature \_\_\_\_\_

PLANE COORDINATE POSITION DATA

State \_\_\_\_\_ Zone \_\_\_\_\_

X \_\_\_\_\_

Y \_\_\_\_\_

Estab. By \_\_\_\_\_

Agency \_\_\_\_\_

DESCRIBE CORNER LOCATION RELATIVE TO NEAR-BY FEATURES, ALSO HOW TO REACH CORNER

Signature John Chaisky Title FIA Division \_\_\_\_\_ Headquarters \_\_\_\_\_ Date June 73

**CORNER RECORD (PERPETUATION)**

**MONUMENT : DESCRIBE NEW MONUMENT SET, OR WORK DONE TO PRESERVE EXISTING MONUMENT**

9

**ACCESSORIES : DESCRIBE NEW BT's WITNESS OBJECTS ETC. ESTABLISHED, OR WORK DONE TO PRESERVE EXISTING EVIDENCE**

10

Work Done By \_\_\_\_\_ Title \_\_\_\_\_ Date \_\_\_\_\_ State Registration No. \_\_\_\_\_  
or Agency \_\_\_\_\_  
Certified Cor. Record Prepared ? Yes No Filed At: \_\_\_\_\_ Date \_\_\_\_\_

11

**REMARKS**

12

Index File No. T. R. M. Tract or Surv. No. Cor. U.S. G.P.O. 1977-725-576/588

13