

USDA-FOREST SERVICE

Index
File No. A 7

CORNER RECORD (SEARCH)
(Ref. FSM 7151.4)

Tract or
Survey No. _____ Cor.
No. _____

T 5N R. 38E R.D. Walla Walla County Umatilla

Merid. Willamette N.F. Umatilla State Oregon

CORNER DIAGRAM

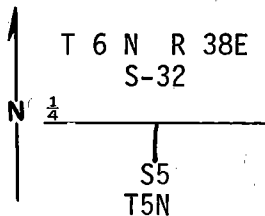

DESCRIBE CORNER MONUMENT FOUND

Found 3" Crown Zellerbach brass cap stamped LS 1294 and set 1980.

DESCRIBE BEARING TREES OR OTHER OFFICIAL ACCESSORIES FOUND

- 1) Found 10" pine with 54-3 sign which reads T5N R38 E Sec. 5 N 29°W 55 ft. GDW 10-10-80
- 2) Found 15" fir with 54-3 sign which reads T5N R38E Sec. 5 N 64°E 62.9' GDW 10-10-80

PHOTO IDENTIFICATION DATA

Photo No. _____

Filed At. _____

Object Ident. _____

Ident. By _____

Signature _____

PLANE COORDINATE POSITION DATA

State _____ Zone _____

X _____

Y _____

Estab. By _____

Agency _____

DESCRIBE CORNER LOCATION RELATIVE TO NEAR-BY FEATURES, ALSO HOW TO REACH CORNER

From intersection of Government Mountain Road (6511) and Road 400 travel north to Road 440 then east and north $\frac{1}{4}$ mile to wood post with location poster then west 700' to corner.

Signature
PAUL TOMPKINS

Title
PLS 2360

Division

Headquarters

Date
7/92

FS-7100-52 (3/68)

CORNER RECORD (PERPETUATION)

MONUMENT: DESCRIBE NEW MONUMENT SET, OR WORK DONE TO PRESERVE EXISTING MONUMENT

ACCESSORIES : DESCRIBE NEW BT'S WITNESS OBJECTS ETC. ESTABLISHED, OR WORK DONE TO PRESERVE EXISTING EVIDENCE

Work Done By _____ Title _____ Date _____ State Registration No. _____
or Agency _____
Certified Cor. Record Prepared ? Yes (No) Filed At: _____ Date _____

REMARKS

Index File No. **A7** T. **5N** R. **38E** M. **W.M.** Tract or Surv. No. _____ Cor. _____

USDA-FOREST SERVICE

Index File No. A-7

CORNER RECORD (SEARCH)

(Ref. FSM 7151.4)

Tract or Survey No. _____ Cor. No. _____

T 5N R. 38E

R.D. W2 County UMATILLA

Merid. WILL

N.F. UMATILLA State OREGON

CORNER DIAGRAM

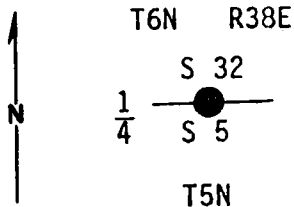

DESCRIBE CORNER MONUMENT FOUND

A diligent search was made and no evidence of stone could be found.

DESCRIBE BEARING TREES OR OTHER OFFICIAL ACCESSORIES FOUND

PHOTO IDENTIFICATION DATA

Photo No. _____
 Filed At. _____
 Object Ident. _____
 Ident. By _____
Signature

DESCRIBE CORNER LOCATION RELATIVE TO NEAR-BY FEATURES, ALSO HOW TO REACH CORNER

PLANE COORDINATE POSITION DATA

State _____ Zone _____
 X _____
 Y _____
 Estab. By _____
Agency

Signature HOWARD PERRY

Title PLS 1294

Division

Headquarters

Date 10/80

7100-52-(3, 6)

CORNER RECORD (PERPETUATION)

Description of monument and accessories I established to perpetuate the original location of this corner:

Set at proportioned point a 1"x30" Galvanized Pipe with 3" brass cap stamped:

Set pipe 24" in ground with mound of stone to cap.

Bearing Trees:

A Ponderosa Pine 6" dia. bears S29°E 55.0 ft., scribed: 1/4 S5 BT.

A Douglas Fir 15" dia. bears S64°W 62.9 ft., scribed: 1/4 S5 BT.

Attached 54-3 and 54-4 signs to both BTs. Attached brass washers to foot blaze of both BTs. Stamped LS 1294. Painted blazes and 6" band around both BTs red.

CROWN ZELLERBACH

T6N R38E
1/4 S32
S5
T5N
1980

OR PLS 1294

10
11

Index File No.

T.

R.

M.

Tract or Surv. No.

Cor.

A-7

5N

38E

12
13

A-7

$$\frac{1}{4} \frac{32}{5} R 38 E$$

TSN

ORIG. SURVEY BY WILLIAMS IN 1872

SEARCH AREA DETERMINED BY MEASUREMENT FROM VICINITY OF $\frac{32}{5} \frac{33}{4}$ AND IS IN AGREEMENT WITH USGS TOPOG. MAP. ORIG. MONUMENT WAS POST AND STONE IN MOUND OF EARTH WITH PITS, NOTED TO BE 6 CHS. WEST OF EDGE OF TIMBER.

OUR SEARCH AREA IS A STEEP WEST SLOPE, PREVIOUSLY LOGGED, CONTAINING MANY FIR AND PINE STUMPS WHICH, BY RING COUNT, WOULD HAVE BEEN LARGE ENOUGH FOR BEARING TREES AT THE TIME OF THE ORIGINAL SURVEY. IT IS ALSO POSSIBLE, THAT OUR SEARCH AREA IS MIS-LOCATED SOMEWHAT SINCE WE ARE PRESENTLY $1\frac{1}{2}$ MILES BY SURVEY LINE FROM THE LAST CONTROLLING CORNER.

NO EVIDENCE FOUND IN THE VICINITY.

5-29-80

Gary L. Langlet
GREG. ORTON

COMPASS DECL: 20° E EAST.

A-7

USDA - FOREST SERVICE

INT
FILE

T M
100

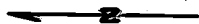

PH PH PH PH PH PH
FD ST X Y LB

USDA-FOREST SERVICE

Index
File No. Z-7

CORNER RECORD (SEARCH)

(Ref. FSM 7151.4)

Tract or
Survey No. _____

Cor.
No. _____

T 6N R. 38E

R.D. WALLA WALLA County UMATILLA

Merid. WILLAMETTE

N.F. UMATILLA State OREGON

CORNER DIAGRAM

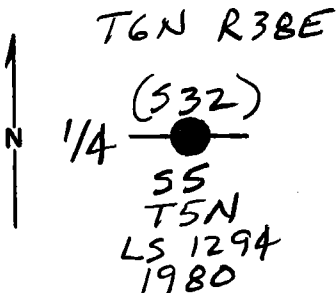

DESCRIBE CORNER MONUMENT FOUND

BRASS CAPPED IRON PIPE SET BY SURVEY BY PERRY IN 1980 & ACCEPTED BY BLM

DESCRIBE BEARING TREES OR OTHER OFFICIAL ACCESSORIES FOUND

PHOTO IDENTIFICATION DATA

Photo No. _____
 Filed At. _____
 Object Ident. _____
 Ident. By _____

Signature

PLANE COORDINATE POSITION DATA

State _____ Zone _____
 X _____
 Y _____
 Estab. By _____

Agency

Signature

Title

Division

Headquarters

Date

FS-7100-52 (3/68)

1990

CORNER RECORD (PERPETUATION)

MONUMENT: DESCRIBE NEW MONUMENT SET, OR WORK DONE TO PRESERVE EXISTING MONUMENT

ACCESSORIES : DESCRIBE NEW BT'S WITNESS OBJECTS ETC. ESTABLISHED, OR WORK DONE TO PRESERVE EXISTING EVIDENCE

Work Done By _____ Title _____ Date _____ State Registration No. _____
or Agency _____

Certified Cor. Record Prepared ? Yes No Filed At: _____ Date _____

REMARKS

Index File No. T. R. M. Tract or Surv. No. Cor.