

OREGON CORNER RESTORATION FORM

Section 5 Township 5N Range 36E
 County Umatilla Date: July 16, 2012

Corner Designation: 5N36C5

Quarter corner common to sections 5 and 6, T5N, R36E,
 W.M., Umatilla County, Oregon.

Condition Report Only
 Not found
 Remonumented
 Unrecorded
 Surveyed in
 Referenced out

Previous Renewals / Surveys, etc.
 Corner was originally set by Odell and Lewis under contract No. 110 dated February 7, 1865.
 Their record reads: Set 1/4 Sec. post. Drove charred stake, dug pits and raised mound as per instructions.

Monument and Accessories found: (condition and source)
 None. This point falls in a plowed field.

DIAGRAM

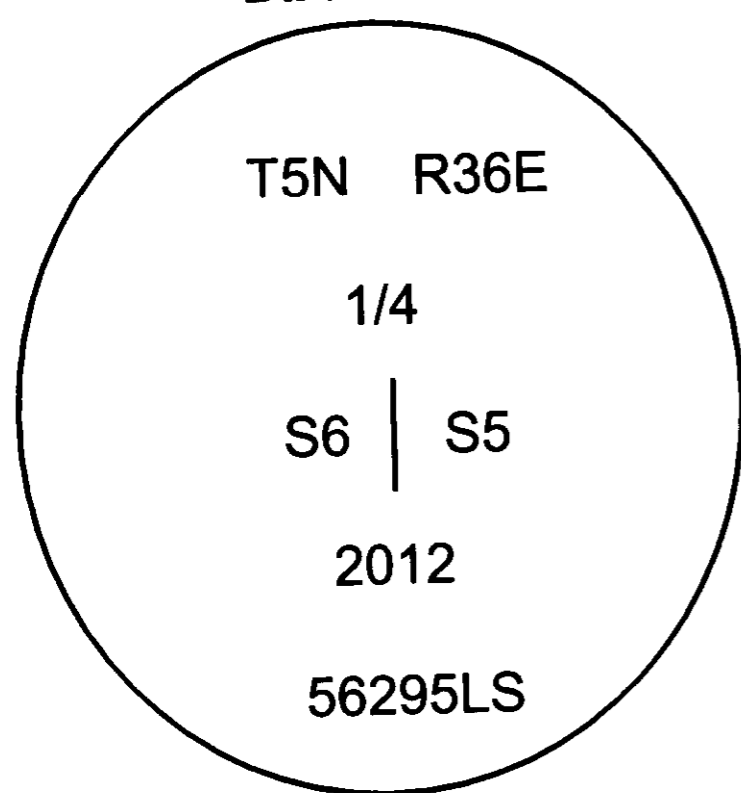

⊗ = Brass Cap
 ● = Rebar Reference

SKETCH

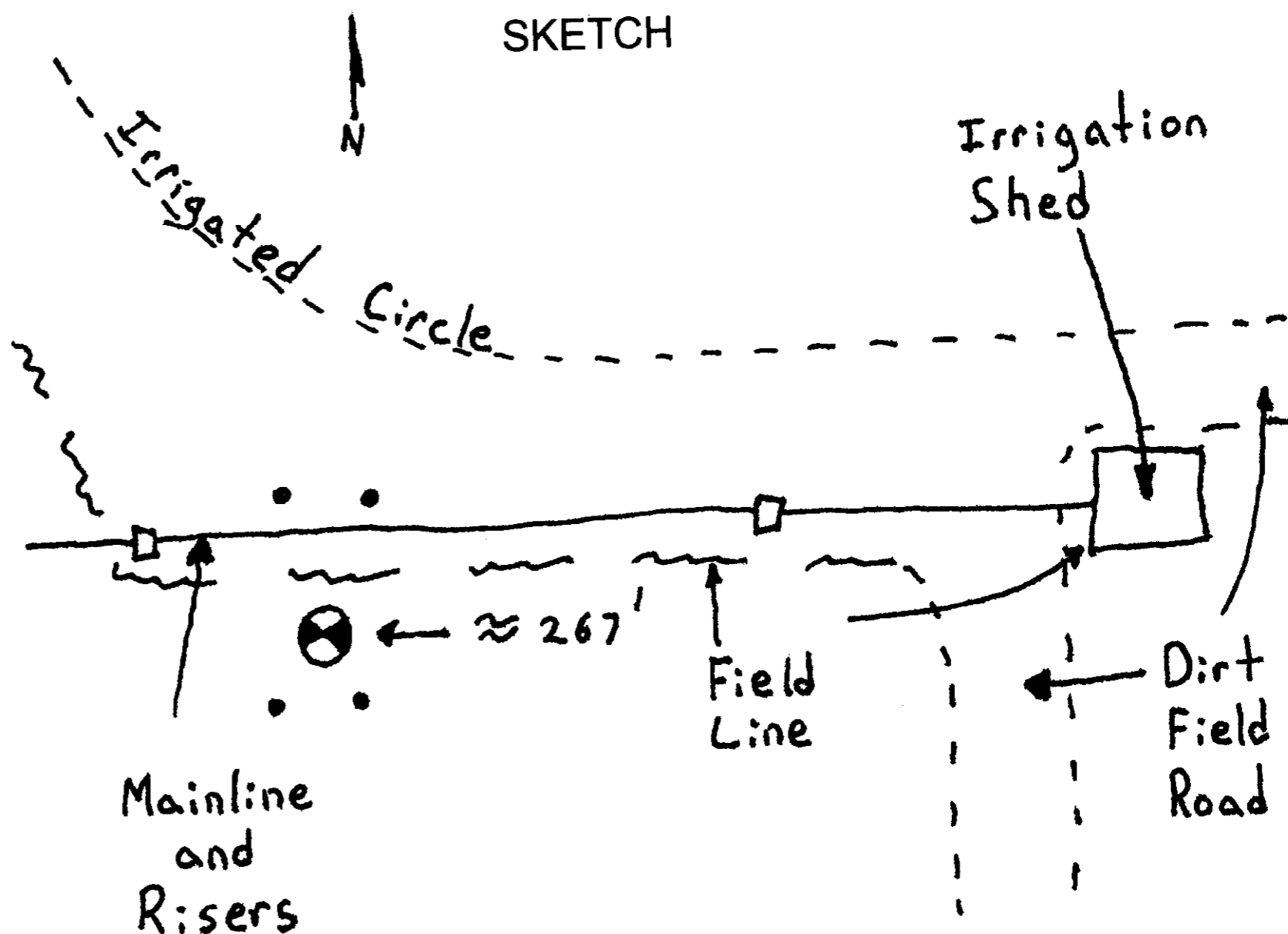

MONUMENT (S) AND ACCESSORIES SET (Procedures and Description)

Set a 1 1/2" x 30" galvanized iron pipe with a 2 3/8" brass cap stamped as shown in the diagram above 2 feet below the surface of the plowed field at the proportioned point.

For references, I set four 5/8" by 24" iron rebars with 1 1/8" orange plastic caps stamped WTS and 56295LS as described below 2 feet below the surface of the plowed field:
 an iron rebar bears N37°30'34"W, 44.34 feet;
 an iron rebar bears N35°39'12"E, 42.15 feet;
 an iron rebar bears S37°53'10"W, 27.22 feet;
 an iron rebar bears S32°58'47"E, 26.92 feet;

The monument was set and references were tied using Trimble R7/R8 RTK GPS.

Location and comments
 NAD 83/1991 State Plane Coordinate
 Oregon North Zone
 N = 836028.28 ift
 E = 8748726.00 ift

Compass Declination

Surveyors Seal

RECEIVED BY:

Umatilla County Surveyor
 Date: 12/6/2012
 Rec'd By: [Signature]
 No. 12-155-B

Firm / Agency
 Witness Tree Surveying
 Address
 P.O. Box G
 Pilot Rock, Or. 97868
 Party Chief
 Stephen K, Haddock

REGISTERED
 PROFESSIONAL
 LAND SURVEYOR

Stephen K. Haddock

OREGON
 JULY 9, 2001
 STEPHEN K. HADDOCK
 56295LS

RENEWAL DATE 6-30-13