

OREGON CORNER RESTORATION FORM

COUNTY: Umatilla. DATE: 03/02/08

CORNER DESIGNATION: Z-25, The Southeast Corner of Section 36, Township 6 North, Range 36 East, W.M.

PREVIOUS RENEWALS/SURVEYS ETC.: Corner was originally established by Odell & Lewis, under GLO Contract No. 110, dated February 7, 1865. Notes state: Set post Cor. For Tps. 5 & 6N., Rs. 36 & 37 E. Drove charred stake; dug pits & raised mound, as per instructions.

Surveyor John Kimbrell, in his surveys recorded at Book 1, Page 492 and Book 2, Page 243, Record of Private Surveys, surveys to this corner but does not report what was found.

MONUMENT AND ACCESSORIES FOUND: None.

MONUMENT MARKING DETAIL:

T6N
R36E R37E
S36 | S31
S1 | S6
T5N
2008
PLS 1106

MONUMENT SET: I held the intersection of a ancient fence line extending from the East with the centerline of County Road to the South as the corner point. At the reestablished corner point, set a 2 3/8" brass cap on a 1 1/4" x 30" galvanized iron pipe, 24" in the ground and surrounded with a mound of stone.

New accessories:

A 3/4" brass washer stamped "PLS 1106", in the North side of a power pole, 1 foot above ground level, bears South 14 1/2° East, 29.2 feet.

A 5/8" rebar (survey control point) bears South 00°13' East, 47.9 feet.

A 5/8" x 24" rebar with a red plastic cap marked "OR PLS 1106, WA PLS 17372", in West cut bank of County Road bears S 49° W, 70.3 feet.

A 5/8" x 24" rebar with a red plastic cap marked "OR PLS 1106, WA PLS 17372" in top of bank on North side of county road bears N 85 1/2° W, 44.3 feet.

Set a steel fence post 1 1/2 feet North of corner with witness sign attached. Attached bearing object signs attached to rebar accessories and power pole. (No bearing object sign on survey control point).

LOCATION AND COMMENTS: Bent over fence running East-West is 2 feet North of corner. North gate post of green gate across driveway is 11 1/2 feet East. Centerline of driveway to green gate is 10 feet South. The County Road extends South and West.

OREGON STATE PLANE COORDINATE, North Zone, NAD 83(91), International Feet:

N = 839676.42
E = 8775267.49

FIRM: Wells Surveying
P.O. Box 1696
Pendleton, OR 97801

COMPASS DECLINATION: 18° East

Surveyor's Seal

Witnesses: Jason Wells, LSIT

\6N36Z25

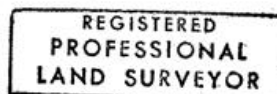

William R. Wells

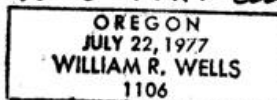

Expires 6-30-10

09-10-c