

OREGON CORNER RESTORATION FORM

COUNTY: Umatilla. DATE: 04/04/08

CORNER DESIGNATION: Z-19, The South One-Quarter Corner of Section 35, Township 6 North, Range 36 East, W.M..

PREVIOUS RENEWALS/SURVEYS ETC.: Corner originally established by Odell & Lewis under GLO Contract No. 110, dated February 7, 1865. Notes state: Set 1/4 Sec. post. Drove charred stake; dug pits & raised mound as per instructions.

MONUMENT AND ACCESSORIES FOUND: None.

MONUMENT MARKING DETAIL:

T6N R36E
1 S35
4 S2
T5N
2008
PLS 1106

MONUMENT SET: Reestablished corner point on the parallel of latitude between the South one-quarter corner of Section 36 and the Southwest corner of Section 35. At the reestablished corner point, set a 2 3/8" brass cap on a 1 1/4" x 30" galvanized iron pipe with cap buried 28" below ground level, cap marked as shown in "Monument Marking Detail".

New accessories:

- A silver deep-1 magnet bears North 79° East, 30.2 feet.
 - A purple deep-1 magnet bears South 04° West, 30.1 feet.
 - A blue deep-1 magnet bears South 83° West, 34.0 feet.
 - An orange deep-1 magnet bears North 17 1/2° West, 28.0 feet.
- Deep-1 magnets are buried 20" below ground level with bearing object signs.

LOCATION AND COMMENTS: No nearby features, falls in a bean field.

OREGON STATE PLANE COORDINATE, North Zone, NAD 83(91), International Feet:

N = 839481.95
E = 8767341.38

FIRM: Wells Surveying
P.O. Box 1696
Pendleton, OR 97801

COMPASS DECLINATION: 18° East

Surveyor's Seal

Witnesses: Jason Wells, LSIT

\6N36Z19

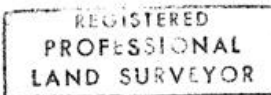

William R. Wells

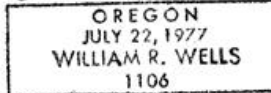

Expires 6-30-10