

OREGON CORNER RESTORATION FORM

COUNTY: Umatilla. DATE: 07/18/08

CORNER DESIGNATION: Z-15, The South Quarter Corner of Section 34, Township 6 North, Range 36 East, W.M..

PREVIOUS RENEWALS/SURVEYS ETC.: Corner originally established by Odell & Lewis under GLO Contract No. 110, dated February 7, 1865. Notes state: Set 1/4 Sec. post. Drove charred stake; dug pits & raised mound, as per instructions. John Kimbrell, during his survey recorded at Book 1, Page 401, Record of Private Surveys, reestablished this corner and set a pipe, 1 1/4 diam. by 2 feet long. Kimbrell also established 1" pipes for the 1/16th corners on the South line of Section 34, 1/4 mile East and West of this corner point.

MONUMENT AND ACCESSORIES FOUND: None. Corner point falls in a 8 foot deep road cut in Whiteman Road. I searched for the pipes set for this corner and the 1/16th corners East and West of this corner point. I did recover a 3/4" by 18" iron bar near the position for the East 1/16th corner, but it was out of the ground and lying on the North bank of Whiteman Road.

MONUMENT MARKING DETAIL:

T6N R36E
1 S34
4 S3
T5N
2008
PLS 1106

MONUMENT SET: I reestablished the corner point on the parallel of latitude between the Southeast and Southwest corners of Section 34. The corner point falls about 6 feet South of the centerline of dirt road known as Whiteman Road. I used a rebar monument with aluminum cap so the top of the monument could be buried below the road surface to allow for further grading of the road. At the reestablished corner point, set a 2" aluminum cap on a 5/8" x 24" rebar, with cap buried 10" below road grade. Monument marked as shown in "Monument Marking Detail".

New accessories:

A 5/8" x 24" rebar with a red plastic cap marked "OR PLS 1106, WA PLS 17372", bears North 61° East, 34.6 feet.

A 5/8" x 24" rebar with a red plastic cap marked "OR PLS 1106, WA PLS 17372", bears South 69° East, 37.2 feet.

A 3/4" brass washer in a power pole, 1 foot above ground level, bears South 80° West, 76.8 feet. Pole located on South side of the road. Nailed witness sign to this power pole.

A 5/8" x 24" rebar with a red plastic cap marked "OR PLS 1106, WA PLS 17372", bears North 54° West, 34.5 feet.

Rebar accessories are set in the North and South road banks of Whiteman Road. Wired bearing object signs to the rebar accessories and nailed bearing object sign to the power pole accessory.

LOCATION AND COMMENTS: Corner falls about 6 feet South of centerline of Whiteman Road, in a deep road cut.

OREGON STATE PLANE COORDINATE, North Zone, NAD 83(91), International Feet:

N = 839298.41
E = 8762019.14

FIRM: Wells Surveying
P.O. Box 1696
Pendleton, OR 97801

COMPASS DECLINATION: 18° East

Witnesses: Jason Wells, LSIT

6N36Z15

Surveyor's Seal

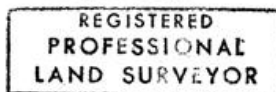

William R. Wells

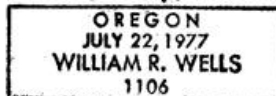

09-10-c