

**OREGON CORNER RESTORATION FORM**

COUNTY: Umatilla DATE: 02/15/05

CORNER DESIGNATION: 5N35, Z-03, The South Quarter Corner of Section 31.

**PREVIOUS RENEWALS/SURVEYS ETC.:**

Corner originally established by Odell & Lewis, under GLO Contract No. 110, dated February 7, 1865. Notes state: Set post Standard Cor. for 1/4 Sec.; land slopes to the E.; drove charred stake, dug pits and raised mound as per instructions.

MONUMENT AND ACCESSORIES FOUND: None.

**MONUMENT MARKING DETAIL:**

SC  
T5N R35E  
1/4 S31  
2005  
PLS 1106

**MONUMENT SET:**

Re-established corner by single proportion measurement between the Southwest corner of Section 31 and the Standard South one-quarter corner of Section 33. The East-West road centerline was held for latitude at the corner common to Secs. 32 and 33. See Survey No. 02-021-C for additional information. This corner falls in wheat field with no nearby features. At re-established corner position, set a 2 1/2" brass cap on 2 1/2" x 30" galvanized iron pipe with cap buried 18" below ground, marked as shown in Monument Marking Detail.

**New accessories:**

- A silver deep-1 magnet bears North 52° East, 45.7 feet, buried 20" below ground.
- A purple deep-1 magnet bears South 37° East, 43.9 feet, buried 20" below ground.
- A blue deep-1 magnet bears South 48° West, 43.5 feet, buried 20" below ground.
- An orange deep-1 magnet bears North 38° West, 44.8 feet, buried 20" below ground.

Buried bearing object signs with the deep-1 magnet accessories.

LOCATION AND COMMENTS: Corner falls in wheat field West of head of draw running South. No other nearby features.

**OREGON STATE PLANE COORDINATES, Oregon North, NAD 83(91), International Feet:**

N = 806276.61  
E = 8715219.86

FIRM: William R. Wells, PLS  
P.O. Box 1696  
Pendleton, OR 97801

COMPASS DECLINATION: 18° East

Surveyor's Seal

Witness: Brian Cole

/5N35Z03

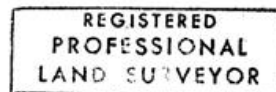

*William R. Wells*

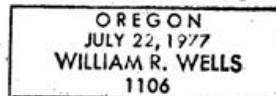

*Renews 6/30/06*