

OREGON CORNER RESTORATION FORM

COUNTY: Umatilla DATE: 02/08/05

CORNER DESIGNATION: 5N35, X-25, The East Quarter Corner of Section 36.

PREVIOUS RENEWALS/SURVEYS ETC.:

Corner originally established by Odell & Lewis, under GLO Contract No. 110, dated February 7, 1865. Notes state: Set post Cor. for 1/4 Sec. Cor. on side hill, facing E.; dug pits; drove charred stake & raised earth mound, as per instructions.

MONUMENT AND ACCESSORIES FOUND: Found 13" x 10" x 6" stone, unmarked, 12" below road surface, surrounded with broken bricks, charcoal and rotted post remains, at intersection of centerline of North-South Basket Mountain County Road with field line and fence extending East and field berm extending West. Also found old 6" spike, which had been graded out. About 1 foot from position of stone.

MONUMENT MARKING DETAIL:

T5N
R35E R36E
1/4
S36 | S31
2005
PLS 1106

MONUMENT SET:

I accepted the stone as the corner and set a 2 1/2" brass cap on 1 1/4" x 30" galvanized iron pipe, with cap 10" below road surface, marked as shown in Monument Marking Detail. Buried found stone North of corner monument.

New accessories:

A 5/8" x 30" rebar with yellow plastic cap marked "OR PLS 1106, WA PLS 17372" bears South 88° East, 18.9 feet, in fence line extending East. Set steel fence post with "witness" sign, 1 foot North of rebar accessory.

A purple deep-1 magnet buried 2.0 feet below ground, bears South 35° East, 23.6 feet.

A 5/8" x 30" rebar with yellow plastic cap marked "OR PLS 1106, WA PLS 17372" bears South 47° West, 28.5 feet.

An orange deep-1 magnet buried 2.0 feet bears North 20° West, 36.6 feet.

Rebar accessories have bearing object signs wired to them. Buried bearing object signs with deep-1 magnets.

LOCATION AND COMMENTS: Corner located in centerline of Basket Mountain Road with field line and fence extending East and field berm extending West.

OREGON STATE PLANE COORDINATE, North Zone, NAD 83(91), International Feet:

N = 809166.87
E = 8744283.74

FIRM: William R. Wells, PLS
P.O. Box 1696
Pendleton, OR 97801

COMPASS DECLINATION: 18° East

Surveyor's Seal

Witnesses: Brian Cole

/5N35X25

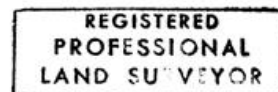

William R. Wells

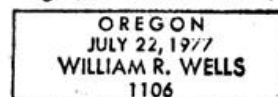

RENEWS 6/30/06

05-112-C