

OREGON CORNER RESTORATION FORM

Section 25 Township 5N Range 34E
 County Umatilla Date: April 17, 2003

Corner Designation: 5N34T25

Quarter corner common to section 25, T5N, R34E and section 30, T5N, R35E, W.M., Umatilla County, Oregon.

Condition Report Only
 Not found
 Remonumented
 Unrecorded
 Surveyed in
 Referenced out

State Plane Coordinates, Oregon North, 83(1991)
 N = 814182.57 E = 8712462.74, The coordinates are from a single GPS tie to Tri Station GEER.

Previous Renewals / Surveys, etc.

Corner originally set by Deputy Surveyors Odell & Lewis under contract No. 110 dated February 7th, 1865. Their record reads: Set charred post Cor. for 1/4 sec.; dug pits & raised mound as per instructions. John Kimbrell in the survey recorded in Book 1, Page 325 of the Record of Private Surveys said "set stone 14 x 7 x 3 for 1/4 sec. cor."

Monument and Accessories found: (condition and source)

Found a broken stone 7 x 7 x 3 at the foot of a railroad tie fence corner. I could find no other stone in the area. There was evidence of other rotted off posts at this corner indicating long term use of this position.

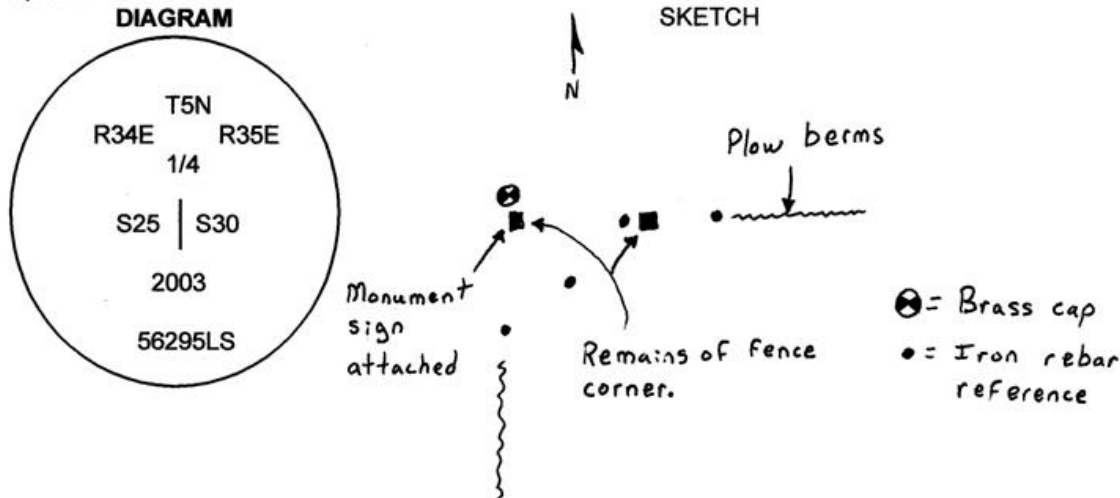

MONUMENT (S) AND ACCESSORIES SET (Procedures and Description)

I set a 2 1/4" brass cap stamped as shown in the daigram above on a 1 1/2" x 30" galvanized iron pipe, 30" at the foot of the railroad tie fence corner. I buried the stone along side.

For references, I set four 5/8" by 24", green coated, iron rebars with 1 1/8" orange plastic caps stamped WTS and 56295LS as described below:

- a rebar bears N87°56'10"E, 26.37 feet, 20" beneath the surface;
- a rebar bears S88°24'14"E, 9.71 feet, 20" beneath the surface;
- a rebar bears S45°27'07"E, 12.08 feet, 20" beneath the surface;
- a rebar bears S2°58'59"W, 12.32 feet, 20" beneath the surface;

The monument and references were tied using a LIECA system 300 RTK GPS.

Location and comments

Compass Declination

Surveyors Seal

RECEIVED BY:
Umatilla County Surveyor
 Date: 10-03
 Rec'd By: KE
 No. 03-314-C

Firm / Agency
 Witness Tree Surveying
 Address
 P.O. Box G
 Pilot Rock, Or. 97868
 Party Chief
 Stephen K, Haddock

REGISTERED
 PROFESSIONAL
 LAND SURVEYOR

Stephen K. Haddock

OREGON
 JULY 9, 2001
 STEPHEN K. HADDOCK
 56295LS

RENEWAL DATE 6-30-05