

OREGON CORNER RESTORATION FORM

SECTION:33 TOWNSHIP: 5N RANGE: 29E Z-11

COUNTY: UMATILLA DATE: 12/05

CORNER DESIGNATION

S1/4 Section 33

- CONDITION REPORT ONLY**
- NOT FOUND**
- RENEWED**
- UNRECORDED**
- SURVEYED IN**
- REFERENCED OUT**

PREVIOUS RENEWALS/SURVEYS ETC.

Originally surveyed by Maxon & Hurd under Contract # 50 in 1860. They set post and made mound. In 1975 Staebler set a 5/8" iron rebar. In 1990 Edwards set a 1"x30" iron pipe with a 2 3/8" brass cap.

MONUMENTS AND ACCESSORIES FOUND: CONDITON AND SOURCE

Found a 2 3/8" brass cap 2" below the pavement stamped as below. W.C. an aluminum tag #951 in a power pole bears S 7° 10' 14" W 16.94' (17.05').

MONUMENT DETAIL

T5NR29E
S1/4 Sec. 33
1990
L.S. 951

OREGON STATE PLANE COORDINATES, NORTH ZONE, NAD 83(91) INT. FEET:

803928.13
8535148.47

MONUMENT SET (PROCEDURES AND DESCRIPTION)

NEW ACCESSORIES FROM WHICH

- A 5/8" x 30" Iron Rebar with plastic cap #951 bears N 77° 56' 50" W 100.16'
- A 5/8" x 30" Iron Rebar with plastic cap #951 bears S 78° 04' 33" W 107.44'
- A 5/8" x 30" Iron Rebar with plastic cap #951 bears S 17° 39' 05" W 15.80'

LOCATION AND COMMENTS

From the intersection of (North) Edwards road with Punkin Center road, go East on Punkin center 0.5 miles to corner.

SURVEYOR'S SEAL

**FIRM: EDWARDS SURVEYING LLC
PO BOX 763 - HERMISTON OR 97838**

**PARTY CHIEF: R. SMITH
WITNESS: J. JOSEPH**

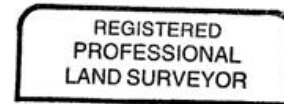

G. Dennis Edwards

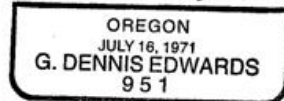

RENEWS 12/31/05