

5-71 V-13

CERTIFIED RECORD OF LAND CORNER MONUMENTATION

History of original corner establishment:

Corner established in 1861 by Timothy W. Davenport under General Land office Contract No. 101.

Surveyor General's Record (notes) states:
Set corner post to Sections 27, 28, 33 & 34, made mound and drove charred stake, as per instructions.

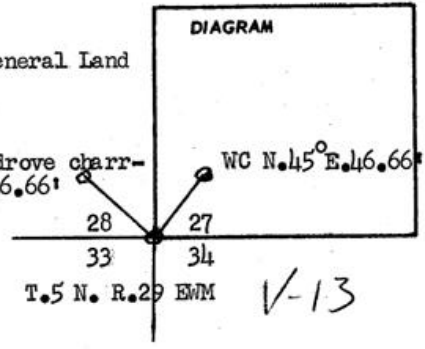

Description of corner evidence found:

Found charcoal at intersections of four roads, near north-south line run between two known section corners.

Description of monument and accessories I established to perpetuate the original location of this corner

Set brass cap monument at exact position of evidence found from which ~~is set~~ **2 W.C.'s.**
A brass capped witness corner bears N.45° W. a distance of 46.66 feet.
A brass capped witness corner bears N.45° E. a distance of 46.66 feet.

REGISTERED PROFESSIONAL LAND SURVEYOR

Ralph P. Thompson

OREGON
MAY 13, 1960
RALPH P. THOMPSON
508

Office of Surveyor County of Umatilla
 State of Oregon, I hereby certify that the within instrument was filed in this office
 for record on the 24 day of May, 1976, at 11:45 o'clock A. (signed)
Wayne O. Harris by Edmund J. Herber
 (COUNTY OFFICIAL) (DEPUTY)

This form is filed in lieu of a survey filed of record which was in error and incomplete, in which work was done for the Umatilla County Road Dept. Dated 5-5-71 File H-30. Map H-30 is hereby canceled and replaced with this certificate.