

OREGON CORNER RESTORATION FORM

SECTION: 30 TOWNSHIP: 5N

RANGE: 29E

R-3

COUNTY: UMATILLA

DATE: 12/05

CORNER DESIGNATION

N 1/4 Section 30

- CONDITION REPORT ONLY
- NOT FOUND
- RENEWED
- UNRECORDED
- SURVEYED IN
- REFERENCED OUT

PREVIOUS RENEWALS/SURVEYS ETC.

Originally surveyed by Davenport under Contract # 101 in 1861. He set post and made mound.

MONUMENTS AND ACCESSORIES FOUND: CONDITION AND SOURCE

Nothing found.

MONUMENT DETAIL

T5NR29E
 1/4 19
 30
 2005
 L.S. 951

OREGON STATE PLANE COORDINATES, NORTH ZONE, NAD 83(91) INT. FEET:

814317.99
 8524368.57

MONUMENT SET (PROCEDURES AND DESCRIPTION)

By single proportion I set a 1"x30" iron pipe in concrete with a 2 3/8" brass cap stamped as above, 8" below the surface of a graveled road.

NEW ACCESSORIES FROM WHICH

- A 5/8" x 30" Iron Rebar with plastic cap #951 bears N 55° 29' 09" E 39.88'
- A 5/8" x 30" Iron Rebar with plastic cap #951 bears N 30° 33' 03" E 29.78'
- A 5/8" x 30" Iron Rebar with plastic cap #951 bears S 4° 12' 02" W 38.04'
- A 5/8" x 30" Iron Rebar with plastic cap #951 bears S 6° 42' 51" E 53.31'

LOCATION AND COMMENTS

Corner is in Progress road 0.5 miles west of Craig road.

SURVEYOR'S SEAL

FIRM: EDWARDS SURVEYING LLC
 PO BOX 763 - HERMISTON OR 97838

PARTY CHIEF: R. SMITH
 WITNESS: J. JOSEPH

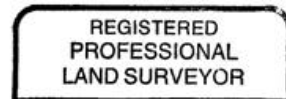

G. Dennis Edwards

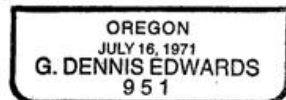

RENEWS 12/31/05