

OREGON CORNER RESTORATION FORM

SECTION: 26 TOWNSHIP: 5N RANGE: 29E R-19

COUNTY: UMATILLA DATE: 12/05

CORNER DESIGNATION

N1/4 Section 26

- CONDITION REPORT ONLY
- NOT FOUND
- RENEWED
- UNRECORDED
- SURVEYED IN
- REFERENCED OUT

PREVIOUS RENEWALS/SURVEYS ETC.

Originally surveyed by Davenport under Contract # 101 in 1861. He set post and made mound.

MONUMENTS AND ACCESSORIES FOUND: CONDITION AND SOURCE

Nothing found.

MONUMENT DETAIL

T5NR29E

1/4 23

26

2005

L.S. 951

OREGON STATE PLANE COORDINATES, NORTH ZONE, NAD 83(91) INT. FEET:

814661.16

8545542.43

MONUMENT SET (PROCEDURES AND DESCRIPTION)

By single proportion I set a 1"x12" iron pipe with a 2 3/8 brass cap in concrete stamped as above 6" above the ground.

NEW ACCESSORIES FROM WHICH

A 5/8" x 30" Iron Rebar with plastic cap #951 bears S 51° 57' 05" E 234.00'

A 5/8" x 30" Iron Rebar with plastic cap #951 bears S 34° 55' 59" E 212.43'

A 5/8" x 30" Iron Rebar with plastic cap #951 bears S 14° 19' 53" E 209.17'

A 5/8" x 30" Iron Rebar with plastic cap #951 bears S 5° 14' 12" W 226.54'

LOCATION AND COMMENTS

From the intersection of Walls road and Marks road, go Northerly on Marks road 0.7 miles to feed lot, then go counter clockwise Northeasterly around a pivot halfway (0.9 miles). Corner lies between two pivot fields.

SURVEYOR'S SEAL

FIRM: EDWARDS SURVEYING LLC
PO BOX 763 - HERMISTON OR 97838

PARTY CHIEF: R. SMITH
WITNESS: J. JOSEPH

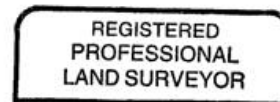

G. Dennis Edwards

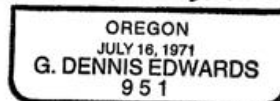

OREGON
JULY 16, 1971
G. DENNIS EDWARDS
951
RENEWS 12/31/05