

OREGON CORNER RESTORATION FORM

SECTION 30 TOWNSHIP 5N RANGE 28 V-3

COUNTY: UMATILLA DATE 4/90

CORNER DESIGNATION

South 1/4 Corner

CONDITION REPORT ONLY

NOT FOUND

RENEWED

UNRECORDED

SURVEYED IN

REFERENCED OUT

PREVIOUS RENEWALS/SURVEYS, ETC.

Under Contract #101, Davenport did original survey in 1861. He set post.

MONUMENTS & ACCESSORIES FOUND: Condition and Source

Nothing found.

MONUMENT DETAIL

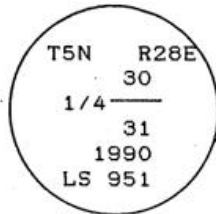

SKETCH

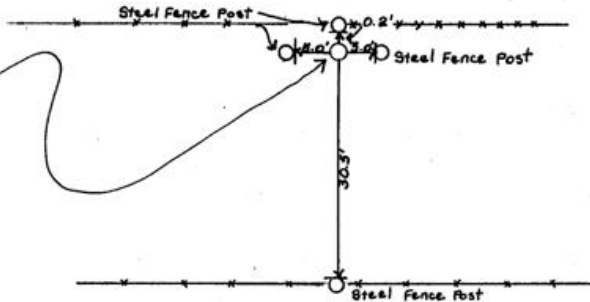

MONUMENT SET (PROCEDURES AND DESCRIPTION)

By single proportion I set 1"x30" iron pipe with 2 3/8" Brass Cap. See County Area One 1989 Survey.

NEW ACCESSORIES

From which
Steel fence post Bears North 0.2 foot,
" " " Bears West 5.0 feet,
" " " Bears South 30.5 feet,
" " " Bears East 5.0 feet.

Attached Bearing Object signs to all accessories. Attached Witness Corner signs to accessories East & West of corner.

LOCATION & COMMENTS

From Radio Station on Power Line Road go West 0.75 mile to Corner.

SURVEYOR'S SEAL

COMPASS DEC.
FIRM EDWARDS SURVEYING
P.O. BOX 763, HERMISTON,
OREGON, 97838
PARTY CHIEF D. EDWARDS
NOTES
WITNESS J. COPPOCK

REGISTERED
PROFESSIONAL
LAND SURVEYOR

G. Dennis Edwards

OREGON
JULY 18, 1971
G. DENNIS EDWARDS
951

RECEIVED BY

Umatilla County Surveyor
Date 1-91
Rec'd By KA
No. 91-01-B