

OREGON CORNER RESTORATION FORM

COUNTY: Umatilla DATE: February 1998

CORNER DESIGNATION: R-5, Northwest Corner Section 29, Township 5 North, Range 28 East, W.M.

PREVIOUS RENEWALS/SURVEYS ETC.: Original GLO Survey by Timothy W. Davenport, under contract No. 101, dated August 5, 1861. Notes state: Set post Cor. to secs. 19, 20, 29 & 30; made mound and drove charred stake, as per instructions. Re-established by David Krumbein, Umatilla County Survey Records #I-16-C, dated 10-30-73. Record states: Set brass cap. Maintained by G. Dennis Edwards, Umatilla County Survey No. 91-01-B, dated January 1991. Record states: Found Krumbein's 1973 Brass Cap stamped as shown in "Monument Marking Detail". Also found Krumbein's 2 1/2" Brass Cap Witness Corner N76°00'50"W 196.27 feet of corner. New Accessories: 3" Iron pipe in concrete 36" above ground Bears N2°03'30"E 203.75 feet. Alum. tag #951 in Power pole Bears S29°35'40"E 35.43 feet. Alum. tag #951 in RR tie fence post Bears S85°45'40"E 8.26 feet. Bearing Object signs attached to all new accessories.

MONUMENT AND ACCESSORIES FOUND: Found a 2 1/2" brass cap flush with edge of roadway marked as shown in "Monument Marking Detail".

Existing Accessories:

A 3" iron pipe in concrete 36" above ground bears N 05° E, 203.75 feet.

An aluminum tag stamped #951 in face of railroad tie bears S 85°45'50" E, 8.26 feet.

A 2 1/2" brass cap witness corner 8" above ground bears N 76°01' W, 196.27 feet.

MONUMENT MARKING DETAIL:

UMATILLA COUNTY

T5N R28E

S19 | S20

S30 | S29

RPE 7728

SURVEYOR

MONUMENT SET:

New Accessories:

The West edge of UECA Pole #290901 (metal pole) bears S 25° E, 37.10 feet.

All accessories have bearing object signs attached except metal power pole.

Witness corner has steel fence post with witness post sign attached 1.0 foot beyond.

Corner has a railroad tie with witness post sign attached, near corner.

LOCATION AND COMMENTS:

Note: Distance from power pole to corner is measured from the side center of pole. South on Powerline Road to Radar Road, turn right (by watertank).

COMPASS DECLINATION: 18° East

Surveyor's Seal

Witnesses: Jason Wells

Benjamin Weinke

Oregon State Plane Coordinates, North Zone, NAD 83(91), Int. Feet:

North: 814001.37

East: 8495151.54

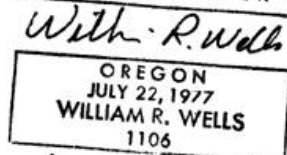
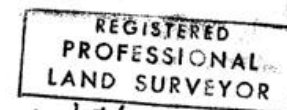

Renews 6-30-98

98-101-C