

OREGON CORNER RESTORATION FORM

Section 22 Township 5N Range 28E

R-13

County UMATILLA Date 11/95

CORNER DESIGNATION

SW. COR

- Condition Report Only
- Not Found
- Renewed
- Unrecorded
- Surveyed In
- Referenced Out

Previous Renewals/Surveys, etc. ORIG. SUR. BY DAVENPORT in 1861 Contat #101  
DEPENDENT SURVEY BY ME IN 1988 Co Contat 1987-1

Monument(s) & Accessories Found: (Condition and Source)

Find W.C. Alum tag #951 in P.Pole N 19° 55' E 80.27 FT. From Cor  
Find W.C. Alum tag #951 in P.Pole S 43° 40' E 5.65 FT. From Cor

Monument Detail

Sketch

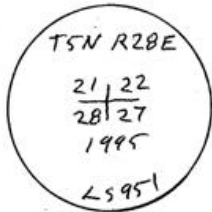

Monument Set (Procedures and Description)

From the Two Witness Corners I set a 1" x 30" I. Pipe  
with 2 3/8" B.C. stamped as above

New Accessories

A RR spike stamped 951 Bears WEST 41.74 FEET  
A 5/8" rebar with 2" Alum Cap Bears S 51° 40' 40" W 93.82 Feet

Location & Comments

AT THE INTERSECTION Compass Declination \_\_\_\_\_  
OF BENSEL RD. Firm/Agency EDWARDS  
E LIND RD. SURVEYING  
 \_\_\_\_\_ Address P.O. BOX 763  
 \_\_\_\_\_ HERMISTON, OR 97838  
 \_\_\_\_\_ Party Chief D. Edwards  
 \_\_\_\_\_ Notes \_\_\_\_\_  
 \_\_\_\_\_ Witness J. Coppock

Surveyor's Seal

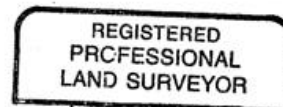

*G. Dennis Edwards*

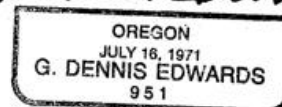

RENEWS 12/31/95

09-40-A