

OREGON CORNER RESTORATION FORM

Section: 17 - 18
Township: 5 North
Range: 28 East of the Willamette Meridian
County: Umatilla
Date: 01/05/2023

Corner Indexing Information: Township 5N Range 28E Corner Code L-5 (Willamette Meridian)

Additional Identifier: Quarter corner between Sections 17 & 18

Oregon Plane Coordinates: N: 821901.93 E: 8495051.68 Zone: North Order: Second

Datum: NAD83-2011(epoch 2010) Convergence: N 00°48'58.60" W Scale Factor: 0.99996910607705

Previous Renewals/Surveys, etc.:

- 1861: Post, mound, pits, & charred stake (Davenport, General Land Office Contract #101)
1907: Iron bolt set 40.00 chains North of Southwest corner Section 17 (J. Kimbrell, C.S. 251)
1910: Corner found, not described (J. Kimbrell, C.S. 308)
1948: Iron bar reported (Storms, C.S. Q-1543-B)
1990: Found splintered 3/4" galvanized pipe with steel plug & punch mark, bent, also steel post with United States Army Corps of Engineers (USACE) witness sign N71°50'E, 1.74' from pipe, origin unknown; replaced pipe with 1" pipe with brass cap; set witness post sign, bearing tree sign, & aluminum tag #951 on light pole N30°47'27"W, 125.57'; Set bearing tree sign & aluminum tag #951 on 9" locust tree N74°19'13"E, 79.51'; set witness post sign, bearing tree, & aluminum tag #951 on park guard post S57°27'17"E, 44.83'; set steel post with witness post sign & bearing tree S81°52'W, 2.10' (Edwards, C.S. 91-001-B)
1998: Recovered 1990 monument; set brass washer #1106 in 12" locust tree, N76°E, 79.33'; set bearing tag on 3" steel pipe 1.6' above ground, S77°W, 95.17'. (W. Wells, C.S. 98-101-C)
2004: Recovered 1990 monument (Primm, LCR 04-155-B)

Monument(s) & Accessories Found (Condition & Source):

Found 2-3/8" brass cap on 2" iron pipe, 2" above surface; Bearing tree sign on t-post bears S82°W, 2.0'; an aluminum tag in a light pole bears N31°34'21"W, 125.57'; a bearing tag on 3" O.D. iron pipe 21" above surface bears S71°24'42"W, 95.27', an aluminum tag on a treated wood guard post bears S58°17'43"E, 44.83.

Monument Set (Procedures & Description):

N/A

Monument Detail:

T5N R28E
1/4 18.17
1990
LS 951

New Accessories: WE SET:

A power pole/light pole on the south side of 7th Street bears N42°55'02"E, 139.60'. Attached bearing object sign to pole.

Location & Comments:

Westerly parking lot of Nugent Park, +/- 300' Northerly of Nugent Park boat ramp.

Compass Declination:

All accessories tied with State Plane grid bearings. In addition to the accessories found and set a 1-5/8" galvanized iron pipe with threaded cap bear S49°38'58"W, 42.08', and a 1-5/8" galvanized iron pipe with a threaded cap bears S72°04'07"W 95.74'

Firm/Agency: PBS Engineering & Environmental, Inc.
5 N. Colville Street
Walla Walla, WA 99362

Witness: Mark F. Wendover
Eduardo C. Ibarra
Hayden J. Lomeli
Felipe G. Hernandez

Surveyor's Seal

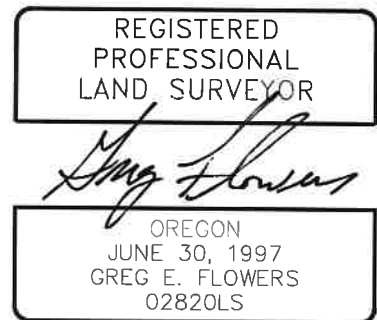

RENEWS 12/31/2025

12/28/2023