

USDA-FOREST SERVICE

Index
File No. Z-3
T 45 R. 33E
Merid. Will.

CORNER RECORD (SEARCH)

(Ref. FSM 7151.4)

Tract or
Survey No. _____
Cor. No. Z-3

R.D. Ukiah County Umatilla
N.F. Umatilla State Ore.

CORNER DIAGRAM

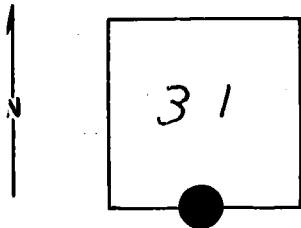

DESCRIBE CORNER MONUMENT FOUND SET

Brass Cap! 1977

DESCRIBE BEARING TREES OR OTHER OFFICIAL ACCESSORIES FOUND

Notes on file! see Monumentation File

PHOTO IDENTIFICATION DATA

Photo No. _____
Filed At. _____
Object Ident. _____
Ident. By _____
Signature

DESCRIBE CORNER LOCATION RELATIVE TO NEAR-BY FEATURES, ALSO HOW TO REACH CORNER

PLANE COORDINATE POSITION DATA

State _____ Zone _____
X _____
Y _____
Estab. By _____
Agency

Signature

Title

Division

Headquarters

Date

7100-52-(3/68)

CORNER RECORD (PERPETUATION)

GPO 902-673

MONUMENT: DESCRIBE NEW MONUMENT SET, OR WORK DONE TO PRESERVE EXISTING MONUMENT

9

ACCESSORIES : DESCRIBE NEW BT'S WITNESS OBJECTS ETC. ESTABLISHED, OR WORK DONE TO PRESERVE EXISTING EVIDENCE

10

Work Done By: _____ Title _____ Date _____ State Registration No. or Agency _____

Certified Cor. Record Prepared? Yes No Filed At: _____ Date _____

11

REMARKS

12

Index File No. T. R. M. Tract or Surv. No. Cor. 13

Index

File No. A-3

CORNER RECORD (SEARCH)

(Ref. FSM 7151.4)

Tract or Survey No. _____

Cor. No. A-3

T 5S R. 33E

R.D. Ukiah

County Umatilla

Merid. W.M.

N.F. Umatilla

State Oregon

CORNER DIAGRAM

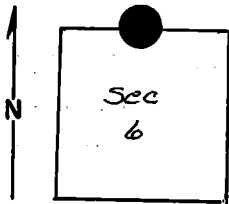

DESCRIBE CORNER MONUMENT FOUND

Found a stone 15x12x5, markings 1/4. Above ground in good condition.

Brass Cap; See Monumentation File

DESCRIBE BEARING TREES OR OTHER OFFICIAL ACCESSORIES FOUND

24" ponderosa pine bearing S 45° E from corner has a good scar for scribing.

PHOTO IDENTIFICATION DATA

Photo No. _____

Filed At. _____

Object Ident. _____

Ident. By _____

Signature

PLANE COORDINATE POSITION DATA

State _____ Zone _____

X _____

Y _____

Estab. By _____

Agency

Signature

M.L. Christain

Title

F.T.

Division _____

Headquarters _____

Date

10/20/76

7100-52-(3/68)

CORNER RECORD (PERPETUATION)

MONUMENT: DESCRIBE NEW MONUMENT SET, OR WORK DONE TO PRESERVE EXISTING MONUMENT

ACCESSORIES : DESCRIBE NEW BT'S WITNESS OBJECTS ETC. ESTABLISHED, OR WORK DONE TO PRESERVE EXISTING EVIDENCE

Painted 6" red band around tree and painted scar plus stone. Attached proper signs to tree. Put a steel post in rock jack where stone is located and put in property and attention sign on it.

Work Done By _____ Title _____ Date _____ State Registration No. _____
or Agency _____

Certified Cor. Record Prepared ? Yes No Filed At: _____ Date _____

REMARKS

Index, File No. T. R. M. Tract or Surv. No. Cor. 13