

USDA-FOREST SERVICE

Index

File No. Z-17

CORNER RECORD (SEARCH)

(Ref. FSM 7151.4)

Tract or

Survey No. _____

Cor.

No. Sec

T 45 R: 33E

R.D. UKIAH

County UMATILLA

Merid. WILLAMETTE

N.F. UMATILLA

State OREGON

CORNER DIAGRAM

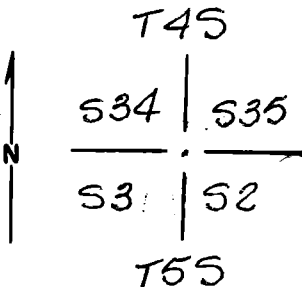

DESCRIBE CORNER MONUMENT FOUND

Found a 2 1/2" dia Brass Cap PLS 644
and a steel fence Post with SIGNS # 54-4

DESCRIBE BEARING TREES OR OTHER OFFICIAL ACCESSORIES FOUND

A 22" dia. Fir bears N 67° E, 83 feet
A 30" dia. Twin Trunk fir bears S 75° E, 22 feet
A 16" dia. fir bears S 12° W 202 feet

PHOTO IDENTIFICATION DATA

Photo No. _____

Filed At. _____

Object Ident. _____

Ident. By _____

Signature

PLANE COORDINATE POSITION DATA

State _____ Zone _____

X _____

Y _____

Estab. By _____

Agency

DESCRIBE CORNER LOCATION RELATIVE TO NEAR-BY FEATURES, ALSO HOW TO REACH CORNER

From Junction of UKIAH-Hilgard Highway and Forest Road
54 drive EAST 0.8 mi Park and Walk South 1000' TO
CORNER

Signature
David H. Klein

Title
PLS 933

Division

Headquarters

Date
6-83

7100-52 (3/68)

CORNER RECORD (PERPETUATION)

MONUMENT: DESCRIBE NEW MONUMENT SET, OR WORK DONE TO PRESERVE EXISTING MONUMENT

9

ACCESSORIES : DESCRIBE NEW BT'S WITNESS OBJECTS ETC. ESTABLISHED, OR WORK DONE TO PRESERVE EXISTING EVIDENCE

PAINTED TREES

REWIRED SIGNS TO FENCE POSTS

10

Work Done By D. Krumbein Title Surveyor Date 6-83 State Registration No. PLS 933
or Agency

Certified Cor. Record Prepared? Yes No Filed At: UMATILLA COUNTY Date 7-83

11

REMARKS

12

Index File No. Z-17 T. 4S R. 33 E M. Willamette Tract or Surv. No. Cor. Sec

13