

USDA-FOREST SERVICE

Index

File No. Y-19

CORNER RECORD (SEARCH)

(Ref. FSM 7151.4)

Tract or

Survey No. _____

Cor.

No. S 1/4 C-C

T 4S R. 33E

R.D. Ukiah

County Umatilla

Merid. Willamette

N.F. Umatilla

State Oregon

CORNER DIAGRAM

T4S R33E

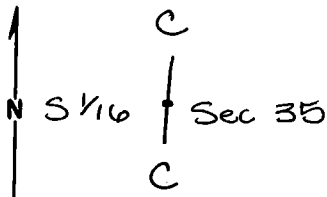

DESCRIBE CORNER MONUMENT FOUND

NONE

DESCRIBE BEARING TREES OR OTHER OFFICIAL ACCESSORIES FOUND

NONE

PHOTO IDENTIFICATION DATA

Photo No. _____

Filed At. _____

Object Ident. _____

Ident. By _____

Signature

PLANE COORDINATE POSITION DATA

State _____ Zone _____

X _____

Y _____

Estab. By _____

Agency

DESCRIBE CORNER LOCATION RELATIVE TO NEAR-BY FEATURES, ALSO HOW TO REACH CORNER

From Junction of Ukiah-Hilgard Highway and Forest Road 54 Go East 1.3 mi, Park and walk uphill 850 Feet to Corner.

Signature

David H Klein

Title PLS 933 Division

Headquarters

Date 3/84 7100-52-(3-68)

CORNER RECORD (PERPETUATION)

MONUMENT: DESCRIBE NEW MONUMENT SET, OR WORK DONE TO PRESERVE EXISTING MONUMENT

Set 2 1/2" Brass Cap on a 2 1/2" x 30" Galvanized Pipe
Set 21" in the Ground Marked!

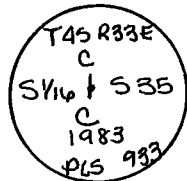

ACCESSORIES: DESCRIBE NEW BT'S WITNESS OBJECTS ETC. ESTABLISHED, OR WORK DONE TO PRESERVE EXISTING EVIDENCE

A 7" Pond. Pipe bears N 64° 30' E 33.0 Feet scribed CS 1/16 S 35.
A 16" Pond. Pipe bears S 32° 15' E 105.5 Feet scribed CS 1/16 S 35.
Blazes are painted red and have red bands painted around them. Trees have signs numbers 54-3, 54-9 and Brass washers stamped PLS 933 nailed to them.

Work Done By D. Krumbein Title Surveyor Date 7/83 State Registration No. PLS 933
or Agency

Certified Cor. Record Prepared? Yes No Filed At: Umatilla County Date 3-1984

REMARKS