

Index

File No. X-15

CORNER RECORD (SEARCH)

(Ref. FSM 7151.4)

Tract or

Survey No. \_\_\_\_\_

Cor.

No. C14

T 45 R. 33E

R.D. UKiah

County UMatilla

Merid. Willamette

N.F. UMatilla

State Oregon

CORNER DIAGRAM

T45 R33E

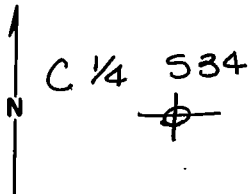

DESCRIBE CORNER MONUMENT FOUND

NONE

DESCRIBE BEARING TREES OR OTHER OFFICIAL ACCESSORIES FOUND

NONE

PHOTO IDENTIFICATION DATA

Photo No. \_\_\_\_\_

Filed At. \_\_\_\_\_

Object Ident. \_\_\_\_\_

Ident. By \_\_\_\_\_

Signature

PLANE COORDINATE POSITION DATA

State \_\_\_\_\_ Zone \_\_\_\_\_

X \_\_\_\_\_

Y \_\_\_\_\_

Estab. By \_\_\_\_\_

Agency

DESCRIBE CORNER LOCATION RELATIVE TO NEAR-BY FEATURES, ALSO HOW TO REACH CORNER

From Jct of UKiah-Hilgard Hwy & Forest Road  
54 GO East 0.3 Mi turn North & GO  
across country 0.3 Mi to corner.

Signature

*David H. Klein*

Title PLS 933 Division

Headquarters

Date 9-1983 7100-52 (3. 68)

CORNER RECORD (PERPETUATION)

MONUMENT: DESCRIBE NEW MONUMENT SET, OR WORK DONE TO PRESERVE EXISTING MONUMENT

Set a 2 1/2" Brass Cap on a 2 1/2" x 30" Galvanized Pipe Set 24" in the Ground Marked:

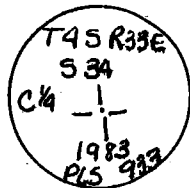

ACCESSORIES: DESCRIBE NEW BT'S WITNESS OBJECTS ETC. ESTABLISHED, OR WORK DONE TO PRESERVE EXISTING EVIDENCE

A 8" Pine bears N 71° E, 29.65 feet Scribed C 1/4 S 34 BT  
A 10" Pine bears N 52° W, 113.40 feet Scribed C 1/4 S 34 BT

Blazes are Painted Red and Trees have Red bands Painted around them.

Trees have SIGNS Numbers 54-3, 54-4 & Brass washers Stamped PLS P 933 Nailed to them.

Work Done By D. Krumbein Title Surveyor Date 7/83 State Registration No. PLS 933  
or Agency

Certified Cor. Record Prepared?  Yes  No Filed At: Umatilla County Date 7-1983

REMARKS