

USDA-FOREST SERVICE

Index File No. N-13
T 4S R. 33E
Merid. Will

CORNER RECORD (SEARCH)
(Ref. FSM 7151.4)

R.D. UKIAH County UMATILLA
N.F. UMATILLA State OREGON

Tract or Survey No. _____
Cor. No. _____

CORNER DIAGRAM

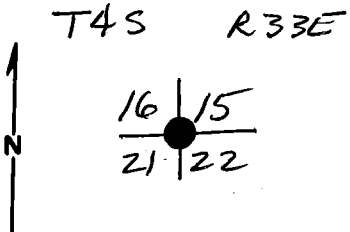

DESCRIBE CORNER MONUMENT FOUND

NONE

DESCRIBE BEARING TREES OR OTHER OFFICIAL ACCESSORIES FOUND 2

DECAYED TAMARACK LOG W/ AXE FACE & FRAGMENTARY SCRIBING BEARS S 53°W, 48.2 ft.

PHOTO IDENTIFICATION DATA 6

Photo No. _____
Filed At. _____
Object Ident. _____
Ident. By _____
Signature

ROOT HOLE & TAMARACK LOG W/ NO VISIBLE MARKS, (BADLY DECAYED) BEARS S 38°E, 74.6 ft.

DESCRIBE CORNER LOCATION RELATIVE TO NEAR-BY FEATURES, ALSO HOW TO REACH CORNER 3

CORNER POINT FALLS IN ROAD No. 54

PLANE COORDINATE POSITION DATA

State _____ Zone _____
X _____
Y _____
Estab. By _____
Agency

Signature Dennis L. Gaylord *Title* _____ *Division* PLS 1636 *Headquarters* _____ *Date* 10-28-81 7100-52-(3.68)

CORNER RECORD (PERPETUATION)

MONUMENT: DESCRIBE NEW MONUMENT SET, OR WORK DONE TO PRESERVE EXISTING MONUMENT

SET 1/2" x 24" REBAR IN ROAD - TOP OF ROD IS 6" BELOW ROAD SURFACE.

ACCESSORIES : DESCRIBE NEW BT'S WITNESS OBJECTS ETC. ESTABLISHED, OR WORK DONE TO PRESERVE EXISTING EVIDENCE

BRASS CAPPED IRON PIPE BEARS EAST, 40.0 FT & IS MARKED:

15" LARCH, S89°30'E, 45.5' "T4S R33E S 22 BT"
 13" DOUG. FIR S71°W, 49.3' "T4S R33E S 21 BT"
 12" DOUG. FIR N62°W, 41.8' "T4S R33E S 16 BT"
 23" POND. PINE N32°E, 126.5' "T4S R33E S 15 BT"

W.C.
 T4S R33E
 516/515
 521/522
 PLS 1636
 1981

Work Done By D. J. Gaylord Title LAND SURVEYOR Date 10-28-81 State Registration No. PLS 1636
 or Agency

Certified Cor. Record Prepared? (Yes) No Filed At: UMATILLA COUNTY SURV. Date NOV. 1981

REMARKS

Index File No.

N-13

T.

4S

R.

33E

M.

WILL.

Tract or Surv. No.

Cor.

USDA-FOREST SERVICE

Index
File No. N-13
T 4S R. 33E
Merid. WILL

CORNER RECORD (SEARCH)

(Ref. FSM 7151.4)

R.D. UKIAH County UMATILLA
N.F. UMATILLA State OREGON

Tract or
Survey No. _____
Cor.
No. _____

CORNER DIAGRAM

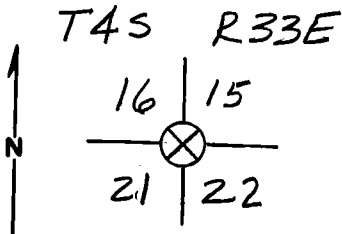

DESCRIBE CORNER MONUMENT FOUND

NONE - FALLS IN Rd 54

DESCRIBE BEARING TREES OR OTHER OFFICIAL ACCESSORIES FOUND

DECAYED REMAINS OF TAMARACK BLAZED FACE WITH FRAGMENTARY SCRIBING VISIBLE LYING IN VICINITY OF ROOT HOLE WHICH BEARS S 53°W, 48.2 ft. ORIG. S.E. BT IS GONE, NE & NW BT LOCATIONS FALL IN ROADWAY, THERE ARE 2 LOCATION POSTERS ON THE EAST SIDE OF THE

ROAD & A LOCATION POSTER IN THE ABOVE MENTIONED ROOT HOLE, DATED 1944. A BLAZED LINE EXTENDS WEST OF THE CORNER. THIS LINE IS ALSO MARKED WITH OLD METAL SALE BDRY. SIGNS.

PHOTO IDENTIFICATION DATA

Photo No. _____
Filed At. _____
Object Ident. _____
Ident. By _____
Signature

PLANE COORDINATE POSITION DATA

State _____ Zone _____
X _____
Y _____
Estab. By _____
Agency

Signature

Title

Division

Headquarters

Date

7100-52-(3.68)

Dennis L. Laylord

PLS 1636

10-9-81

CORNER RECORD (PERPETUATION)

MONUMENT : DESCRIBE NEW MONUMENT SET, OR WORK DONE TO PRESERVE EXISTING MONUMENT

ACCESSORIES : DESCRIBE NEW BT'S WITNESS OBJECTS ETC. ESTABLISHED, OR WORK DONE TO PRESERVE EXISTING EVIDENCE

Work Done By _____ Title _____ Date _____ State Registration No. _____
or Agency _____
Certified Cor. Record Prepared ? Yes No Filed At: _____ Date _____

REMARKS

Index File No. T. R. M. Tract or Surv. No. Cor.

Index
File No. N-13

CORNER RECORD (SEARCH)

(Ref. FSM 7151.4)

T 4 S R. 33 E

R.D. Ukiah

County Umatilla

Tract or
Survey No. _____

Cor.
No. _____

Merid. Will.

N.F. Umatilla

State Oregon

CORNER DIAGRAM

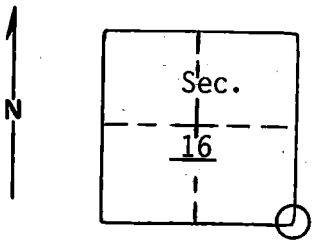

DESCRIBE CORNER MONUMENT FOUND

Material: None

Markings: None. Corner appears to fall in roadway.

DESCRIBE BEARING TREES OR OTHER OFFICIAL ACCESSORIES FOUND

No B.T.'s. Old blazed lines in all 4 cardinal directions. Section line marker board and location poster on 6 inch fir, approx. 12 ft. east of road shoulder.

PHOTO IDENTIFICATION DATA

Photo No. _____

Filed At. _____

Object Ident. _____

Ident. By _____

Signature

PLANE COORDINATE POSITION DATA

State _____ Zone _____

X _____

Y _____

Estab. By _____

Agency

Signature

Title

Division

Headquarters

Date

7100-52-(3/68)

B. Moore

5-77

CORNER RECORD (PERPETUATION)

MONUMENT: DESCRIBE NEW MONUMENT SET, OR WORK DONE TO PRESERVE EXISTING MONUMENT

9

ACCESSORIES : DESCRIBE NEW BT'S WITNESS OBJECTS ETC. ESTABLISHED, OR WORK DONE TO PRESERVE EXISTING EVIDENCE

I opened blazed western larch in SE quadrant which could have been a B.T. but found no scribing.

10

Work Done By _____ Title _____ Date _____ State Registration No. or Agency _____

Certified Cor. Record Prepared? Yes No Filed At: _____ Date _____ 11

REMARKS

The $\frac{1}{4}$ corner $\frac{1}{2}$ mile south was not found.
 The section corner 1 mile south has reliable evidence.
 The $\frac{1}{4}$ corner $\frac{1}{2}$ mile north and the section corner 1 mile east both have reliable evidence.
 Nothing found at $\frac{1}{4}$ corner location $\frac{1}{2}$ mile east.

12

Index File No.

T.

R.

M.

Tract or Surv. No.

Cor.

13