

USDA-FOREST SERVICE

Index File No. L-13

T 48 R. 33E

Merid. W.M.

CORNER RECORD (SEARCH)

N. Fk. (Ref. FSM 7151.4)

Tract or Survey No. _____ Cor. No. _____

R.D. John Day County Umatilla

N.F. Umatilla State Or.

CORNER DIAGRAM

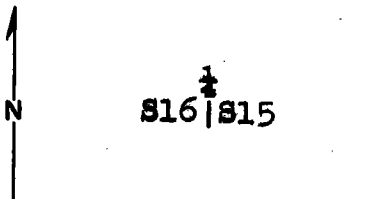

DESCRIBE CORNER MONUMENT FOUND

2 1/2" iron pipe with brass cap mtd. in stone mound.

T48 R33E

S16/S15
1977

DESCRIBE BEARING TREES OR OTHER OFFICIAL ACCESSORIES FOUND

P. Pine, 17", S61°E, 11.9'; with scribing visible.
P. Pine, 24", N83°W, 13.2'; with scribing visible.

PHOTO IDENTIFICATION DATA

Photo No. _____

Filed At. _____

Object Ident. _____

Ident. By _____

Signature

PLANE COORDINATE POSITION DATA

State _____ Zone _____

X _____

Y _____

Estab. By _____

Agency

Signature

J. J. Munro

Title

Division

Headquarters

Date

4/28/87

FS-7100-52 (3/68)

CORNER RECORD (PERPETUATION)

MONUMENT: DESCRIBE NEW MONUMENT SET, OR WORK DONE TO PRESERVE EXISTING MONUMENT

ACCESSORIES : DESCRIBE NEW BT'S WITNESS OBJECTS ETC. ESTABLISHED, OR WORK DONE TO PRESERVE EXISTING EVIDENCE

BTs have blaze and 6" band painted red., BT tags and "Attention" signs. There is a 6' steel fence post with an "Attention" sign within 5' of the corner.

10

Work Done By. F.S. Munro Title PLS Date 4/21/87 State Registration No. 1832
or Agency

Certified Cor. Record Prepared ? Yes No Filed At: _____ Date _____

11

REMARKS

12

Index File No. L-13 T. 48 R. 33E M. W.M. Tract or Surv. No. _____ Cor. _____

13