

Index

File No. R-25

R.D.: N.F.J.D.

Co. Survey No:

T.4S., R.32E.

N.F.: UMATILLA

County: Umatilla

Meridian: Willamette

CORNER DIAGRAM	DESCRIBE CORNER MONUMENT FOUND
T4S	Found iron monument, in a mound of stone, with a brass
R32E R33E	cap marked as shown in DIAGRAM. Monument is solid and
<u>S241S19</u>	firm.
S251S30	
1977	DESCRIBE BEARING TREES OR OTHER OFFICIAL ACCESSORIES FOUND
(BLM Cap)	Ponderosa Pine, 26" dia., with scribing visible, bears
	N27°50'W, 56.3 ft. (Org. Rec: N28°W, 87 lks; BLM Rec:
	N26°W, 87 lks.)
PHOTO ID DATA	Ponderosa Pine, 22" dia., healed blaze chopped on with
Photo No.	no scribing visible, bears S30°58'W, 48.4 ft. (Org. Rec.
Filed At	S27°W, 48.84 ft. BLM Rec: S32°W, 48.84 ft.)
Object ID	Ponderosa Pine, 10" dia., with scribing visible, bears
	N34°58'W, 31.3 ft. (BLM Rec: N33½°W, 31.02 ft.)
PLANE CO-ORD	Ponderosa Pine, 9" dia., down scribing visible, bears
State Zone	S37°30'E, 54.3 ft. (BLM Rec: S36°E, 54.45 ft)
X	Ponderosa Pine, 9" dia., down scribing visible, bears
Y	N47°13'E, 23.2 ft. (BLM Rec: N49½°E, 23.43 ft.)
Estab. By	DESCRIBE CORNER LOCATION: Old N-S road is 50 ft. west.

Signature:

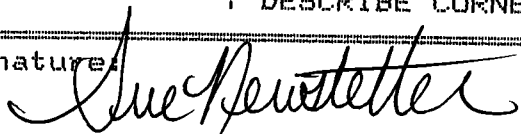

Title: Land Surveyor Date: 10/17/94

CORNER RECORD (PERPETUATION)

MONUMENT: DESCRIBE NEW MONUMENT SET, OR WORK DONE TO PRESERVE EXISTING MON.
No work is needed on the monument.

From Which:

ACCESSORIES: DESCRIBE NEW BT'S, W.O.'S ETC. ESTABL./WORK DONE TO PRESERVE
Ponderosa Pine, 12" dia, bears N26°15'E, 74.3 ft., scribed: T4S R33E S19 BT
Ponderosa Pine, 10" dia, bears S12°00'E, 48.7 ft., scribed: T4S R33E S30 BT
Ponderosa Pine, 10" dia, bears S03°30'W, 38.8 ft., scribed: T4S R32E S25 BT
Measurements to BT's taken with a magnetic compass, declination 20° East,
and a nylon clad steel tape. Set steel fence post with Land Survey
Monument (54-9) sign 5' south of the monument. Nailed a brass washer
stamped PLS 2405 on blaze above BT scribe as taken this survey. Nailed
Bearing Tree (54-3) signs above blaze and Land Survey Monument (54-9) signs
on back of each tree as required. Painted a 6" red band above Bearing
Trees signs.

Work Done by: Susan E. Newstetter Dr. Land Surveyor No. 2405 Date: 10/17/94
Certified Cor. Record Prepared? Yes No Filed At: Umatilla Co. Survey.

REMARKS

Index File No. R-25

T.4S., R.32E., W.M.

Index File No. R-1
T 4S R. 33E
Merid. Willamette

CORNER RECORD (SEARCH)
(Ref. FSM 7151.4)
R.D. Ukiah County Umatilla
N.F. Umatilla State Oregon

Tract or Survey No. 5-20 Cor. No. R-1

CORNER DIAGRAM

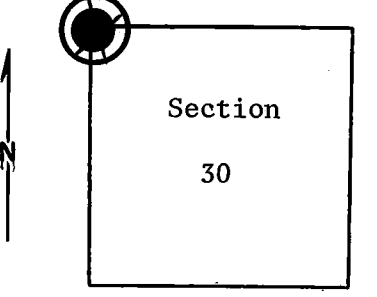

DESCRIBE CORNER MONUMENT FOUND

~~See R-25, R4S, R32E, W.M.~~

Brass Cap! see Monumentation File

DESCRIBE BEARING TREES OR OTHER OFFICIAL ACCESSORIES FOUND

PHOTO IDENTIFICATION DATA

Photo No. _____
Filed At. _____
Object Ident. _____
Ident. By _____
Signature

DESCRIBE CORNER LOCATION RELATIVE TO NEAR-BY FEATURES, ALSO HOW TO REACH CORNER

PLANE COORDINATE POSITION DATA

State _____ Zone _____
X _____
Y _____
Estab. By _____
Agency

Signature T, Hollamon Title Engineering Technician Division _____ Headquarters S, O, Date April 5, 1974
7100-52-(3/68)

CORNER RECORD (PERPETUATION)

MONUMENT : DESCRIBE NEW MONUMENT SET, OR WORK DONE TO PRESERVE EXISTING MONUMENT

9

ACCESSORIES : DESCRIBE NEW BT'S WITNESS OBJECTS ETC. ESTABLISHED, OR WORK DONE TO PRESERVE EXISTING EVIDENCE

10

Work Done By _____ Title _____ Date _____ State Registration No. or Agency _____

Certified Cor. Record Prepared ? Yes No Filed At: _____ Date _____

11

REMARKS

12

Index File No. T. R. M. Tract or Surv. No. Cor. _____

13