

**CERTIFIED RECORD OF LAND CORNER MONUMENTATION**

N-9

**History of original corner establishment:**

Corner originally established by George S. Pershin, U.S. Deputy Surveyor, under Contract No. 390, dated May 12, 1881. Surveyor General records state: Set basalt stone 20x10x8 and post in mound of stone on S.W. slope for cor to Sec 16, 17, 20 & 21. A Pine 32 in. di. brs. N56°E, 213 lks. dist. no other trees near. Corner remonumented by Craig L. Wanless, BLM Cadastral Surveyor under instructions dated July 18, 1977. His record states: The cor. of secs. 16, 17, 20 & 21, determined at record bearing and distance from the original bearing tree: A pine 38 ins. diam., bears N56°E, 213 lks. dist., with fragmentary scribe marks visible on partially healed blaze. At corner point... Set an iron post, 28 ins. long, 2½ ins. diam., 8 ins. in ground, to solid rock, and in a mound of stone, 4 ft. base, to top, with brass cap mkd. (as shown in corner diagram) from which new bearing trees... A ponderosa pine 15 ins. diam., bears S49°E, 177½ lks. dist., mkd. T4SR32ES21 BT. A ponderosa pine 13 ins. diam., bears S53°W, 309 lks. dist., mkd. T4SR32ES20 BT. A ponderosa pine 10 ins. diam., bears N30½°W, 286 lks. dist., mkd. T4SR32ES17 BT.

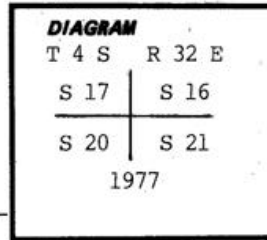

**Description of corner evidence found:**

Found 2½" iron pipe with ¾" brass cap (as shown in corner diagram) in mound of stone.

- A 12" ponderosa pine brs S52°W, 203.5' dist. with scribing visible.
- A 12" ponderosa pine brs N32°W, 188.3' dist with scribing visible.
- A ponderosa pine sawn stump about 8' high 32" diam. brs N53¼°E, 140.1' with scribing visible.
- A 21" ponderosa pine brs S50¼°E, 117.3' with scribing visible.

**Description of monument and accessories established to perpetuate the original location of this corner:**

Set steel fence post next to corner with sign 54-9 & 54-2 attached.

New bearing tree established:

A 13" ponderosa pine brs N66°3/4°E, 162.0' dist. scribed T4SR32ES16 BT.

New BT has a brass washer stamped PLS 1106 nailed to face of blaze. Attached sign 54-3 & 54-9, painted face of blaze & a 6" red band around each BT.

Compass declination 18° East.

I hereby certify that the above corner monument was properly maintained to U.S.F.S. standards by me on June 02, 1992.

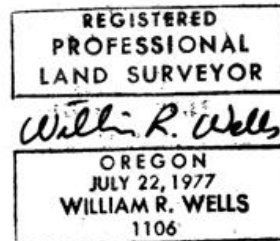

Office of...County Surveyor..... County of...Umatilla.....  
 State of...Oregon....., I hereby certify that the within instrument was filed in this office  
 for record on the..... day of....., 19.....  
 ..... by .....  
 (COUNTY OFFICIAL) (DEPUTY)

Form R6-7100-57 (9/71)

RECEIVED BY  
 Umatilla County Surveyor  
 Date 7-9-92  
 Rec'd By KK  
 No. 92-80-B

★ GPO-788-276

N-9