

# RECORD OF LAND CORNER MONUMENTATION

NORTH QUARTER CORNER OF SECTION 17, T. 4 S., R. 32 E., W.M.

**ORIGINALLY ESTABLISHED BY:** George S. Pershin, U.S. Deputy Surveyor

**CONTRACT NUMBER:** 390

**CONTRACT DATE:** May 12, 1881

**SUBSEQUENT SURVEYS:**

- ▶ Survey by Barry B. Barbour, PLS 1051, filed as Survey No. O-67-A, performed during October - December, 1977. Remonumentation of Certian Original Corner Points, Township 4 South, Range 32 East, performed by Craig L. Wanless, Cadastral Surveyor under Group No. 350 and approved on January 23, 1980.

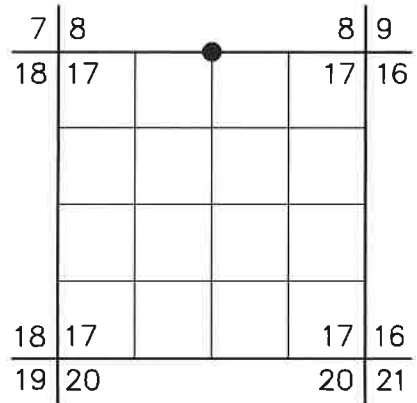

**ORIGINAL DESCRIPTION:**

Set a basalt Stone 12x10x8 on S.E. Slope for ¼ Sec. cor.

A Pine 30 in. di. brs. N.68°E. 72 lks. dis.

A Pine 32 in. di. brs. S.53°W. 13 lks. dis.

**WANLESS' DESCRIPTION:**

The ¼ sec. cor. of secs. 8 and 17, monumented with the original unmarked basalt stone, 12 x 10 x 8 ins., firmly set 6 ins. in the ground, from which the remains of the original bearing trees:

A ponderosa pine, 38 ins. diam., bears N. 68° E., 72 lks. dist., with healed blaze.

A ponderosa pine snag, 37 ins. diam., bears S.64°W., 13 lks. dist., with scribe marks ¼ S visible on open blaze. (Record, S. 53° W.)

At the corner point

Set an iron post, 28 ins. long, 2½ ins. diam., 22 ins. in the ground, with brass cap mkd. (diagram shown) from which a new bearing tree

A lodgepole pine, 13 ins. diam., bears S. 25½° E., 61 lks. dist., mkd. ¼ S17 BT.

Deposit corner stone alongside iron post.

**EVIDENCE FOUND:**

Found a 2½" iron post with standard ¾" BLM brass cap, marked as shown on the diagram, projecting 14" above ground in collar of stone with 2 ft. base, 10" tall. From which the original bearing trees:

A ponderosa pine snag, 30" dbh, bears N.68°E., 47.5 ft.

A ponderosa pine, 20" dbh, bears S.25½°E., 40.3 ft., with healed blaze in good condition.

A ponderosa pine snag, 29" dbh, bears S.64°W., 13 lks., found uprooted snag.

**DESCRIPTION OF MONUMENTS AND ACCESSORIES SET AND METHODS USED:**

I accept the position of the found monument for the corner.

From which, **I SCRIBE NEW BEARING TREES:**

- ▶ A ponderosa pine, 15" dbh, bears N.35°E., 18.9 ft., scribed 1/4S8BT.
- ▶ A ponderosa pine, 16" dbh, bears S.56°W., 39.0 ft., scribed 1/4S17BT.
- ▶ A ponderosa pine, 12" dbh, bears N.24°W., 18.7 ft., scribed X in upper blaze and BT in lower blaze.

CORNER MONUMENT MARKED:

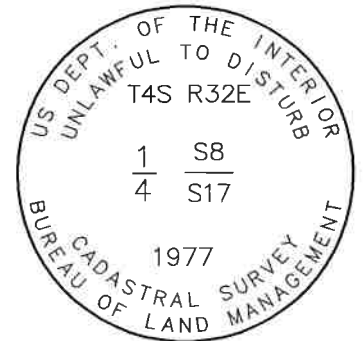

Painted a 6" red band around each bearing tree, and also painted blazes red and attached USFS 54-3 and 54-9 signs as needed. Distances to new bearing trees measured with a handheld EDM to a 60d nail driven in the right-side-center above the root crown, with a 1½" aluminum washer stamped PLS 91693. Bearings measured with a handheld compass with 14° east declination. Set an aluminum post, 3 ft. north with a USFS 54-9 sign attached.

**RESTORATION BY, STAMP AND DATE:**

Work performed June 24, 2024 by:

T. DeJesus Quinones, LSIT

USDA FOREST SERVICE  
NORTHEAST OREGON LAND ZONE  
1550 Dewey Avenue, Suite A  
Baker City, OR 97814  
(541) 523-1281



*Robert C. Moyers*

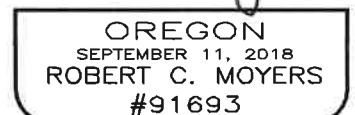

RENEWS: 12/31/2024

24-077-B