

RECORD OF LAND CORNER MONUMENTATION

NORTHWEST SECTION CORNER OF SECTION 17, T. 4 S., R. 32 E., W.M.

ORIGINALLY ESTABLISHED BY: George S. Pershin, U.S. Deputy Surveyor

CONTRACT NUMBER: 390

CONTRACT DATE: May 12, 1881

SUBSEQUENT SURVEYS:

- ▶ Survey by Barry B. Barbour, PLS 1051, filed as Survey No. O-67-A, performed during October - December, 1977.
- ▶ Remonumentation of Certian Original Corner Points, Township 4 South, Range 32 East, performed by Craig L. Wanless, Cadastral Surveyor under Group No. 350 and approved on January 23, 1980.

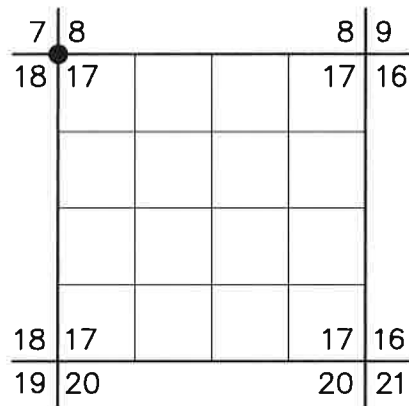

ORIGINAL DESCRIPTION:

- Set basalt stone 16x12x5 on east face of ridge for cor. to Sec 7, 8, 17, and 18
- A Fir 10 in. di. brs. N.63°E. 38 lks. dist.
- A Fir 20 in. di. brs. S.74°E. 70 lks. dist.
- A Pine 18 in. di. brs. S.55°W. 10 lks. dist.
- A Pine 10 in. di. brs. N.33°W. 89 lks. dist.

WANLESS' DESCRIPTION:

The cor. of secs. 7, 8, 17, and 18, determined at record bearing and distance from the remains of the original bearing trees:

- A pine stump, size indeterminate, bears N. 63° E., 38 lks. dist., with a down and decayed pine alongside, with scribe marks S8 visible on open blaze. (Record, fir)
- A root hole, bears N. 33° W., 89 lks. dist.

At the corner point

Set an iron post, 28 ins. long, 2½ ins. diam., 22 ins. in the ground, with brass cap mkd. (diagram shown) from which new bearing trees

- A fir, 10 ins. diam., bears N. 37½° E., 52½ lks. dist., mkd. T4S R32E S8 BT.
- A fir, 12 ins. diam., bears S. 37° E., 78 lks. dist., mkd. T4S R32E S17 BT.
- A fir, 10 ins. diam., bears S. 32° W., 82 lks. dist., mkd. T4S R32E S18 BT.
- A fir, 11 ins. diam., bears N. 64½° W., 103 lks. dist., mkd. T4S R32E S7 BT.

EVIDENCE FOUND:

Found a 2½" iron post with standard 3¼" BLM brass cap, marked as shown on the diagram, projecting 10" above ground.

From which an original bearing tree:

A pine stump, bears N.63°E., 25.1 ft., found decayed stump.

From which Wanless' bearing trees:

- A Fir, 11" dbh, bears N.37½°E., 34.7 ft., found dead & down with stump in ground.
- A Fir, 9" dbh, bears S.37°E., 51.5 ft., found dead, down & uprooted.
- A Fir, 9" dbh, bears S.32°W., 54.1 ft., found dead & down.
- A Fir, 13" diameter, bears N.64½°W., 68.0 ft., found rotten stump.

An 8" diameter wood fence corner post, braced with rock jack, is 1.3 ft. west of corner with fence lines extending west and south.

DESCRIPTION OF MONUMENTS AND ACCESSORIES SET AND METHODS USED:

I accept the position of the found monument for the corner.

From which, **I SCRIBE NEW BEARING TREES:**

- ▶ A tamarack, 10" dbh, bears N.62°E., 14.8 ft., scribed T4SR32ES17BT.
- ▶ A douglas fir, 14" dbh, bears N.78°W., 32.4 ft., scribed T4SR32ES7BT.

Also from which, **I SET NEW REFERENCE MONUMENTS:**

- ▶ A ½" x 24" iron rod, bears N.34°E., 10.0 ft., with attached 2" aluminum cap marked RM 1 2024 PLS 91693.
- ▶ A ¾" x 24" iron rod, bears S.36°W., 7.95 ft., with attached 2" aluminum cap marked RM 2 2024 PLS 91693.

CORNER MONUMENT
MARKED:

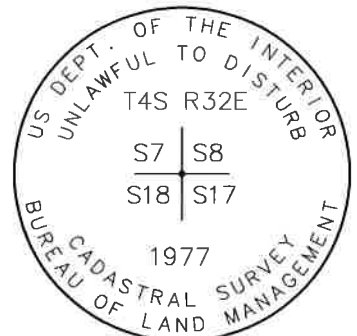

Painted a 6" red band around each bearing tree, and also painted blazes red and attached USFS 54-3 and 54-9 signs. Distances to reference monuments measured with steel tape. Distances to bearing trees measured with a handheld EDM to a 60d nail driven in the right-side-center above the root crown, with a 1½" aluminum washer stamped PLS 91693. Bearings measured with a handheld compass with 14° east declination. Set aluminum posts with USFS 54-2 and 54-9 signs attached, 4 ft. south and 5 ft. west.

RECORD OF LAND CORNER MONUMENTATION

NORTHWEST SECTION CORNER OF SECTION 17, T. 4 S., R. 32 E., W.M.

RESTORATION BY, STAMP AND DATE:

Work performed June 25, 2024 by:

T. DeJesus Quinones, LSIT

USDA FOREST SERVICE
NORTHEAST OREGON LAND ZONE
1550 Dewey Avenue, Suite A
Baker City, OR 97814
(541) 523-1281

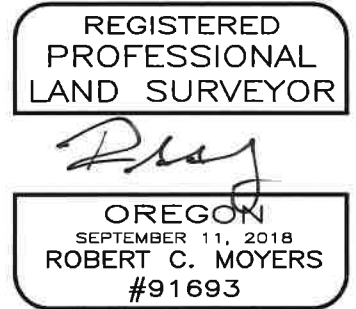

RENEWS: 12/31/2024

24-077-B