

USDA-FOREST SERVICE

Index File No. J-25

CORNER RECORD (SEARCH)

(Ref. FSM 7151.4)

Tract or Survey No. _____ Cor. No. _____

T 45 R. 30&31E

R.D. Ukiah County Umatilla

Merid. Willamette

N.F. Umatilla State Oregon

25

CORNER DIAGRAM

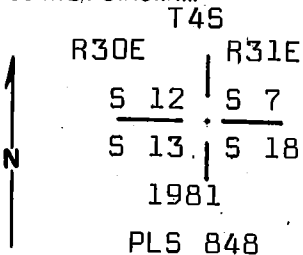

DESCRIBE CORNER MONUMENT FOUND

After making a thorough search of the area, no evidence is found. No trees or remains of trees correspond to original notes.

DESCRIBE BEARING TREES OR OTHER OFFICIAL ACCESSORIES FOUND

Corner is determined to be lost due to logging in the area; therefore corner position is determined by proportion.

PHOTO IDENTIFICATION DATA

Photo No. _____
 Filed At. _____
 Object Ident. _____
 Ident. By _____
Signature

DESCRIBE CORNER LOCATION RELATIVE TO NEAR-BY FEATURES, ALSO HOW TO REACH CORNER

Corner is on slight East slope at bottom of East slope, N-S fence approx. 40 ft. East from corner.

PLANE COORDINATE POSITION DATA

State _____ Zone _____
 X _____
 Y _____
 Estab. By _____
Agency

[Signature]
 Signature

Title _____ Division _____ Headquarters _____ Date _____
 PLS 848 Mt. Vernon, OR 8/14/81

7100-52-(3/68)

CORNER RECORD (PERPETUATION)

MONUMENT: DESCRIBE NEW MONUMENT SET, OR WORK DONE TO PRESERVE EXISTING MONUMENT

Set 3"x30" galv. iron pipe with 3" brass cap stamped as shown on the diagram, set 25 inches in the ground.

From which:

ACCESSORIES : DESCRIBE NEW BT's WITNESS OBJECTS ETC. ESTABLISHED, OR WORK DONE TO PRESERVE EXISTING EVIDENCE

A fir 18 in. dia. bears N47°W, 13.7 ft. scribed T4S, R30E, S 12 BT.
 A tamarack 6 in. dia. bears North, 6.8 ft. scribed X BT.
 A fir 15 in. dia. bears S65°E, 28.2 ft. scribed T4S, R31E, S 18 BT.
 A fir 8 in. dia. bears S 27°W, 4.4 ft. scribed T4S, R30E, S 13 BT.
 Set steel post with warning sign 4 ft. North from corner.
 Nailed bearing tree signs and brass washers stamped PLS 848
 to each tree. Painted red band around each tree.

Work Done By D.M. Ferguson Title Surveyor Date 8/14/81 State Registration No. OR PLS 848
 or Agency

Certified Cor. Record Prepared Yes No Filed At: Umatilla Co. Surv. Off. Date 10/81

REGISTERED
**PROFESSIONAL
 LAND SURVEYOR**

OREGON
 JULY 12, 1968
DOUGLAS M. FERGUSON
 848

REMARKS

Witnesses to above corner:
 D. Mitchell Ferguson
 Mike Woodward

Index
File No. J-25
T 4S R. 30E
Merid. Willamette

CORNER RECORD (SEARCH)
(Ref. FSM 7151.4)

Tract or
Survey No. 4-140 Cor. No. J-25
County Umatilla

R.D. Ukiah State Oregon
N.F. Umatilla

CORNER DIAGRAM

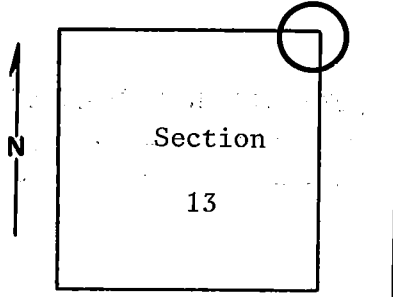

DESCRIBE CORNER MONUMENT FOUND

Material: None.

DESCRIBE BEARING TREES OR OTHER OFFICIAL ACCESSORIES FOUND

There is a north-south fence on this line. There is a 24-inch Douglas-fir in fence line which leans heavily south. It has an aluminum tag on the east side with the following scratched on it: "B.T. Do not cut this tree." I can see no clear evidence that it is a B.T. Approximately 35 feet east of this tree is a 30-inch Douglas fir, also leaning south, which has an old "Oregon State Board of Forestry" location poster on its east (cont. block 12)

DESCRIBE CORNER LOCATION RELATIVE TO NEAR-BY FEATURES, ALSO HOW TO REACH CORNER

A primitive road crosses the north-south fence approximately 1,200 feet north.

PHOTO IDENTIFICATION DATA

Photo No. _____
Filed At. _____
Object Ident. _____
Ident. By _____
Signature

PLANE COORDINATE POSITION DATA

State _____ Zone _____
X _____
Y _____
Estab. By _____
Agency

Signature T. Hollamon Title Engineering Technician Division _____ Headquarters S. O. Date May 31, 1974 7100-52-(3/68)

CORNER RECORD (PERPETUATION)

MONUMENT : DESCRIBE NEW MONUMENT SET, OR WORK DONE TO PRESERVE EXISTING MONUMENT

9

ACCESSORIES : DESCRIBE NEW BT's WITNESS OBJECTS ETC. ESTABLISHED, OR WORK DONE TO PRESERVE EXISTING EVIDENCE

Since there was no reliable evidence, I put up no tags.

10

Work Done By _____ Title _____ Date _____ State Registration No. or Agency _____

Certified Cor. Record Prepared ? Yes No Filed At: _____ Date _____ 11

REMARKS

(Block #3, cont.)

side. This poster indicates that the approximate corner location is 90 feet west. If this is true, the assumed B.T. in the fence line would be in approximately the proper location for the original SE B.T. Also, there is an old down tree (which may be pine) which would then be in approximately the proper location for the original SW B.T. No other evidence.

12

Index File No. T. R. M. Tract or Surv. No. Cor. 13