

Index File No. G-25

T 4 S R. 31 E

Merid. Willamette

CORNER RECORD (SEARCH)

(Ref. FSM 7151.4)

Tract or Survey No. 118-75 Cor. No. G-25

R.D. Ukiah County Umatilla

N.F. Umatilla State Oregon

CORNER DIAGRAM

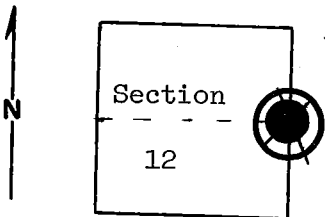

DESCRIBE CORNER MONUMENT FOUND

Material: Stone Mound.

(4" x 4' post in mound of stone)

Brass Cap! see Monumentation File

DESCRIBE BEARING TREES OR OTHER OFFICIAL ACCESSORIES FOUND

A 12" p.pine bears N 47° E, approximately 40' distance from mound with closed blaze on SW face and BLM B.T. poster dated 6/9/~~1954~~.

A down and rotten tree bears S 82° W, approximately 15' from mound. There is a BLM B.T. poster on it. Scribing is visible under side of tree.

DESCRIBE CORNER LOCATION RELATIVE TO NEAR-BY FEATURES, ALSO HOW TO REACH CORNER

A north-south fence is 5' west of mound.

PHOTO IDENTIFICATION DATA

Photo No. _____

Filed At. _____

Object Ident. _____

Ident. By _____

Signature

PLANE COORDINATE POSITION DATA

State _____ Zone _____

X _____

Y _____

Estab. By _____

Agency

Signature B. Moore Title Engineering Technician

Division _____ Headquarters _____

Date April 1975 7100-52-(3/68)

CORNER RECORD (PERPETUATION)

MONUMENT : DESCRIBE NEW MONUMENT SET, OR WORK DONE TO PRESERVE EXISTING MONUMENT

9

ACCESSORIES : DESCRIBE NEW BT's WITNESS OBJECTS ETC. ESTABLISHED, OR WORK DONE TO PRESERVE EXISTING EVIDENCE

10

Work Done By _____ Title _____ Date _____ State Registration No. or Agency _____

Certified Cor. Record Prepared ? Yes No Filed At: _____ Date _____

11

REMARKS

12

Index File No. T. R. M. Tract or Surv. No. Cor. _____

13

USDA-FOREST SERVICE

Index
File No. G-1

CORNER RECORD (SEARCH)

(Ref. FSM 7151.4)

Tract or
Survey No. _____ Cor. No. G-1

T 4S R. 32E

R.D. VKluh County Umatilla

Merid. with

N.F. Umatilla State Oregon

CORNER DIAGRAM

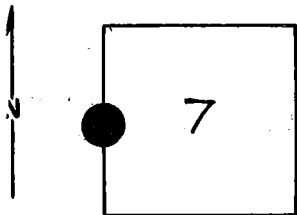

DESCRIBE CORNER MONUMENT - ~~FOUND~~ SET

Brass Cap: 1977

DESCRIBE BEARING TREES OR OTHER OFFICIAL ACCESSORIES FOUND

Notes on file: see Monumentation File

PHOTO IDENTIFICATION DATA

Photo No. _____

Filed At. _____

Object Ident. _____

Ident. By _____

Signature

PLANE COORDINATE POSITION DATA

State _____ Zone _____

X _____

Y _____

Estab. By _____

Agency

Signature

Title

Division

Headquarters

Date

7100-52-(3/68)

CORNER RECORD (PERPETUATION)

GPO 902-673

MONUMENT: DESCRIBE NEW MONUMENT SET, OR WORK DONE TO PRESERVE EXISTING MONUMENT

9

ACCESSORIES: DESCRIBE NEW B.Y.'S WITNESS OBJECTS ETC. ESTABLISHED, OR WORK DONE TO PRESERVE EXISTING EVIDENCE

10

Work Done By _____ Title _____ Date _____ State Registration No. _____
or Agency _____

Certified Cor. Record Prepared? Yes No . Filed At: _____ Date _____ 11

REMARKS

12

Index File No. T. R. M. Tract or Surv. No. Cor. 13