

USDA-FOREST SERVICE

Index

File No. R-17

CORNER RECORD (SEARCH)

(Ref. FSM 7151.4)

Tract or

Survey No. \_\_\_\_\_

Cor.

No. \_\_\_\_\_

T 4S

R. 30E

R.D. Ukiah

County Umatilla

State \_\_\_\_\_

Or. \_\_\_\_\_

Merid. W.M.

N.F. Umatilla

State \_\_\_\_\_

Or. \_\_\_\_\_

CORNER DIAGRAM



T4S R30E  
 S22 | S23  
 S27 | S26

DESCRIBE CORNER MONUMENT FOUND

2 1/2" I.P. with B.C. mkd:

T4S R30E  
 S22 | S23  
 S27 | S26  
 1978

DESCRIBE BEARING TREES OR OTHER OFFICIAL ACCESSORIES FOUND

- P. pine, 10", N1-3/4°E, 84.0 ft.
- P. pine, 39", S16°E, 22.3 ft.
- P. pine, 31", S67-3/4°W, 64.8 ft.
- P. pine, 17", N43 1/2°W, 43.9 ft.

PHOTO IDENTIFICATION DATA

Photo No. 380-79

Filed At. S.O.

Object Ident. trees

Ident. By F.S. Munro

*F.S. Munro* Signature

PLANE COORDINATE POSITION DATA

State \_\_\_\_\_ Zone \_\_\_\_\_

X \_\_\_\_\_

Y \_\_\_\_\_

Estab. By \_\_\_\_\_

Agency \_\_\_\_\_

DESCRIBE CORNER LOCATION RELATIVE TO NEAR-BY FEATURES, ALSO HOW TO REACH CORNER

Cor. falls on gentle E. slope. From end of 037 rd. go E. to fence, N. along fence to cor.

Signature

*F.S. Munro*

Title

L.S.

Division

Headquarters

Date

9/26/84

7100-52 (3-68)

CORNER RECORD (PERPETUATION)

MONUMENT: DESCRIBE NEW MONUMENT SET, OR WORK DONE TO PRESERVE EXISTING MONUMENT

None.

ACCESSORIES : DESCRIBE NEW BT'S WITNESS OBJECTS ETC. ESTABLISHED, OR WORK DONE TO PRESERVE EXISTING EVIDENCE

BTs have reqd. paint, tags & signs.

Work Done By F.S. Munro Title L.S. Date 9/18/84 State Registration No. 1832  
or Agency

Certified Cor. Record Prepared? Yes No  Filed At: \_\_\_\_\_ Date \_\_\_\_\_

REMARKS

Index File No. R-17 T. 48 R. 30E M. W.M. Tract or Surv. No. \_\_\_\_\_ Cor. \_\_\_\_\_

Index  
File No. R-17  
T 4 S. R. 30 E.  
Merid. Willamette

**CORNER RECORD (SEARCH)**  
(Ref. FSM 7151.4)

Tract or Survey No. \_\_\_\_\_  
Cor. No. \_\_\_\_\_

4-111

R.D. Ukiah County Umatilla  
N.F. Umatilla State Oregon

**CORNER DIAGRAM**

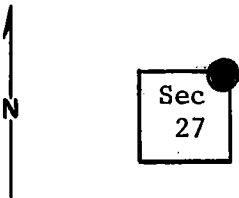

**DESCRIBE CORNER MONUMENT FOUND**

Basalt stone, 17"x8"x7" (similar to GLO notes), 12" above ground, good condition but disturbed.  
2 notches on south edge, 2 notches on east edge. 3 or 4 other stones around it.

*Monumented By BLM, 1978*

**DESCRIBE BEARING TREES OR OTHER OFFICIAL ACCESSORIES FOUND**

A 38" p. pine bears S.14<sup>0</sup>E., approx. 22 ft. (fits GLO Notes). scribing visible 14" deep through small opening. Tree shows rapid growth and is very limby with multiple top.  
A 30" p. pine bears S.65<sup>0</sup>W., approx. 65 ft. (fits GLO notes) scribed T4S, R30E, S27. SE tree has old location poster, SW tree has old "Attention" (against destruction) poster.

**DESCRIBE CORNER LOCATION RELATIVE TO NEAR-BY FEATURES, ALSO HOW TO REACH CORNER**

Stone sets exactly in north-south fence line (Forest boundary) at east edge of strip of mature timber. Land is mostly open north, south and east.  
There is a primitive road approx. 260 ft. west.

**PHOTO IDENTIFICATION DATA**

Photo No. \_\_\_\_\_  
Filed At. \_\_\_\_\_  
Object Ident. \_\_\_\_\_  
Ident. By \_\_\_\_\_  
*Signature*

**PLANE COORDINATE POSITION DATA**

State \_\_\_\_\_ Zone \_\_\_\_\_  
X \_\_\_\_\_  
Y \_\_\_\_\_  
Estab. By \_\_\_\_\_  
*Agency*

Signature	Title	Division	Headquarters	Date	7100-52-(3/68)
T, Hollamon	Eng, Tech,		S,O,	5/8/74	



**CORNER RECORD (PERPETUATION)**

**MONUMENT : DESCRIBE NEW MONUMENT SET, OR WORK DONE TO PRESERVE EXISTING MONUMENT**

**ACCESSORIES : DESCRIBE NEW BT's WITNESS OBJECTS ETC. ESTABLISHED, OR WORK DONE TO PRESERVE EXISTING EVIDENCE**

I placed a location poster on a 12" p. pine, approx. 15 ft. west of old road approx. 270 ft. west of corner.  
I also placed a blank B.T. tag on each B.T.

Work Done By \_\_\_\_\_ Title \_\_\_\_\_ Date \_\_\_\_\_ State Registration No. \_\_\_\_\_  
or Agency \_\_\_\_\_

Certified Cor. Record Prepared ? Yes No Filed At: \_\_\_\_\_ Date \_\_\_\_\_

**REMARKS**

Index File No. T. R. M. Tract or Surv. No. Cor.