

4-136

Index  
 File No. R-25  
 T 4 S.      R. 29 E.  
 Merid. Willamette

**CORNER RECORD (SEARCH)**  
 (Ref. FSM 7151.4)

Tract or  
 Survey No.                      Cor.  
 No.                       
 County Umatilla & Morrow Co., Ore.  
 State Oregon

**CORNER DIAGRAM**

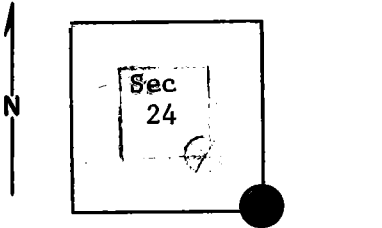

**DESCRIBE CORNER MONUMENT FOUND**

*Brass Cap! See Monumentation File*  
~~See R-1, T. 4 S., R. 30 E.~~

**DESCRIBE BEARING TREES OR OTHER OFFICIAL ACCESSORIES FOUND**

**PHOTO IDENTIFICATION DATA**

Photo No.                       
 Filed At.                       
 Object Ident.                       
 Ident. By                       
*Signature*

**DESCRIBE CORNER LOCATION RELATIVE TO NEAR-BY FEATURES, ALSO HOW TO REACH CORNER**

**PLANE COORDINATE POSITION DATA**

State              Zone               
 X                       
 Y                       
 Estab. By                       
*Agency*

Signature  
T. Hollamon

Title  
Eng, Tech,

Division

Headquarters

S.O,

Date

5/30/74

7100-52-(3/68)

**CORNER RECORD (PERPETUATION)**

**MONUMENT: DESCRIBE NEW MONUMENT SET, OR WORK DONE TO PRESERVE EXISTING MONUMENT**

9

**ACCESSORIES : DESCRIBE NEW BT'S WITNESS OBJECTS ETC. ESTABLISHED, OR WORK DONE TO PRESERVE EXISTING EVIDENCE**

10

Work Done By \_\_\_\_\_ Title \_\_\_\_\_ Date \_\_\_\_\_ State Registration No. or Agency \_\_\_\_\_

Certified Cor. Record Prepared ? Yes No Filed At: \_\_\_\_\_ Date \_\_\_\_\_

11

**REMARKS**

12

Index File No. T. R. M. Tract or Surv. No. Cor. \_\_\_\_\_

13

Index File No. R-1  
 T 4 S.        R. 30 E.         
 Merid. Willamette

**CORNER RECORD (SEARCH)**  
 (Ref. FSM 7151.4)

Tract or Survey No.                      Cor. No.           

R.D. Ukiah County Umatilla & Morrow County Line  
 N.F. Umatilla State Oregon

**CORNER DIAGRAM**

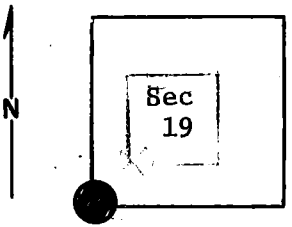

**DESCRIBE CORNER MONUMENT FOUND**

Stone mound, 2' diam., 10" deep, fair condition. No markings visible.

*Brass Cap! See Monumentation File*

**DESCRIBE BEARING TREES OR OTHER OFFICIAL ACCESSORIES FOUND**

A 22" p.pine bears N. 20°E., approx. 45 ft., scribing closed. This tree has an old B.T. tag.  
 A 34" p.pine stump (12" high) bears S. 38°E., approx. 112 ft. B.T. scribed near ground. has been logged.  
 A 24" p.pine bears N. 61°W., approx. 50 ft. Scribing visible. It has a location poster on it. (Cont. in block 12)

**PHOTO IDENTIFICATION DATA**

Photo No.                       
 Filed At.                       
 Object Ident.                       
 Ident. By                       
*Signature*

**DESCRIBE CORNER LOCATION RELATIVE TO NEAR-BY FEATURES, ALSO HOW TO REACH CORNER**

**PLANE COORDINATE POSITION DATA**

State            Zone             
 X                       
 Y                       
 Estab. By                       
*Agency*

Signature T. Hollamon Title Eng, Tech, Division            Headquarters S,O, Date 5/30/74 7100-52-(3/68)

CORNER RECORD (PERPETUATION)

MONUMENT: DESCRIBE NEW MONUMENT SET, OR WORK DONE TO PRESERVE EXISTING MONUMENT

ACCESSORIES : DESCRIBE NEW BT'S WITNESS OBJECTS ETC. ESTABLISHED, OR WORK DONE TO PRESERVE EXISTING EVIDENCE

I placed a B.T. tag on the B.T. in the NW quadrant; also a B.T. tag on the B.T. stump in the SE quadrant. I also placed a location poster on an 8" p.pine at east edge of a primitive road approx. 300 ft. west of corner.

Work Done By \_\_\_\_\_ Title \_\_\_\_\_ Date \_\_\_\_\_ State Registration No. or Agency \_\_\_\_\_

Certified Cor. Record Prepared ? Yes No Filed At: \_\_\_\_\_ Date \_\_\_\_\_

REMARKS

(Cont. from block 3)

There is a location poster and a section line marker board on a 40" p. pine approx. 800 ft. north.

There is also a county line sign beside it. The sign and the 40" tree are about 10-20 ft. north of a primitive road.

Index File No. T. R. M. Tract or Surv. No. Cor.
R-1 45 30 E