

USDA-FOREST SERVICE

Index File No. P-17

CORNER RECORD (SEARCH)

(Ref. FSM 7151.4)

Tract or Survey No. _____ Cor. No. _____

4S R. 30E

R.D. Ukiah County Umatilla

Merid. Willamette

N.F. Umatilla State Oregon

CORNER DIAGRAM

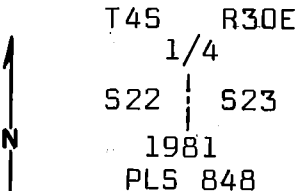

DESCRIBE CORNER MONUMENT FOUND Found old circle of stone in N-S and SE fence corner. Found 16"x8"x5" stone, 1/4 visible in fence rock jack 20 ft. South of circle of stone. Due to harmony with surrounding corners, the center of the circle of stone is accepted as 1/4 corner position.

DESCRIBE BEARING TREES OR OTHER OFFICIAL ACCESSORIES FOUND

No bearing trees established.

PHOTO IDENTIFICATION DATA

Photo No. _____
 Filed At. _____
 Object Ident. _____
 Ident. By _____
 Signature _____

DESCRIBE CORNER LOCATION RELATIVE TO NEAR-BY FEATURES, ALSO HOW TO REACH CORNER

Corner is approximately 500 ft. South of ridge road, where the road crosses a cattle guard. Follow the fence South to corner.

PLANE COORDINATE POSITION DATA

State _____ Zone _____
 X _____
 Y _____
 Estab. By _____
 Agency _____

Signature _____

Title _____ Division _____ Headquarters _____ Date _____
 Surveyor _____ Mt. Vernon, OR 7/28/81

7100-52-(3.68)

CORNER RECORD (PERPETUATION)

MONUMENT: DESCRIBE NEW MONUMENT SET, OR WORK DONE TO PRESERVE EXISTING MONUMENT

Set 3"x30" galv.iron pipe with 3" brass cap, stamped as shown on the diagram. Set 16" in the ground. Placed original stone North alongside the pipe and raised a mound of stone around the pipe.

ACCESSORIES : DESCRIBE NEW BT's WITNESS OBJECTS ETC. ESTABLISHED, OR WORK DONE TO PRESERVE EXISTING EVIDENCE

No bearing trees available
Set steel fence posts with warning and boundary signs 5 ft. East and 5 ft. South from corner.

Work Done By D.M. Ferguson Title Surveyor Date 7/28/81 State Registration No. OR PLS 848
or Agency

Certified Copy Required? Yes No Filed At: Umatilla Co. Surveyor's Off Date 10/81

**PROFESSIONAL
LAND SURVEYOR**

REMARKS

Witnesses to above corner:

D. Mitchell Ferguson
Dave Herburger

**OREGON
JULY 12, 1968
DOUGLAS M. FERGUSON
848**

Index
 File No. P-17
 T 4 S. R. 30 E.
 Merid. Willamette

CORNER RECORD (SEARCH)
 (Ref. FSM 7151.4)

Tract or
 Survey No. _____
 Cor. No. _____

R.D. Ukiah County Umatilla
 N.F. Umatilla State Oregon

CORNER DIAGRAM

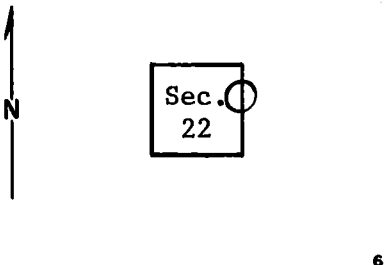

DESCRIBE CORNER MONUMENT FOUND

Basalt stone, 17"x8"x7" (fits GLO notes), good condition (disturbed). 1/4 readable. Stone is in rock-jack 20 ft. south of fence corner. There is a stone mound 2 ft. north of fence corner. It appears that center stone (and 2 or 3 others) has been removed.

DESCRIBE BEARING TREES OR OTHER OFFICIAL ACCESSORIES FOUND

Fence runs north-south and east from stone mound. Location on open south slope. No B.T.'s

PHOTO IDENTIFICATION DATA

Photo No. _____
 Filed At. _____
 Object Ident. _____
 Ident. By _____
Signature

DESCRIBE CORNER LOCATION RELATIVE TO NEAR-BY FEATURES, ALSO HOW TO REACH CORNER

Location is 430 ft. south of cattleguard on road between highway 395 and Log Springs (fits GLO Notes)

PLANE COORDINATE POSITION DATA

State _____ Zone _____
 X _____
 Y _____
 Estab. By _____
Agency

Signature

Title Division Headquarters Date

T, Hollamon

Eng, Tech,

S, O,

5/8/74

7100-52-(3/68)

CORNER RECORD (PERPETUATION)

MONUMENT : DESCRIBE NEW MONUMENT SET, OR WORK DONE TO PRESERVE EXISTING MONUMENT

ACCESSORIES : DESCRIBE NEW BT'S WITNESS OBJECTS ETC. ESTABLISHED, OR WORK DONE TO PRESERVE EXISTING EVIDENCE

I placed a location poster on a fence post at fence junction (2 ft. south of mound) and another location poster on a tree on north side of road near cattleguard (450' north of corner).

Work Done By _____ **Title** _____ **Date** _____ **State Registration No. or Agency** _____

Certified Cor. Record Prepared ? Yes No **Filed At:** _____ **Date** _____

REMARKS

Index File No. T. R. M. **Tract or Surv. No.** **Cor.**