

Index File No. N-9
 T 4 S. R. 30 E.
 Merid. Willamette

CORNER RECORD (SEARCH)
 (Ref. FSM 7151.4)

Tract or Survey No. _____
 Cor. No. _____
 R.D. Ukiah County Umatilla
 N.F. Umatilla State Oregon

CORNER DIAGRAM

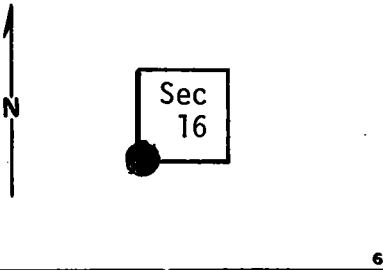

DESCRIBE CORNER MONUMENT FOUND

Stone mound, 2' dia., 8" deep, 8" above ground, fair condition.
 Cannot identify corner stone.

Monumented By BLM, 1978

DESCRIBE BEARING TREES OR OTHER OFFICIAL ACCESSORIES FOUND

A 28" p.pine bears N.18⁰E., approx. 53 ft. Scribed T4S., R30E., S16. (Fits GLO Notes). It has an old location poster on it.
 A 28" p.pine bears N. 18⁰W. approx. 70 ft (fits approx. GLO location). I can see no evidence of scribing or blazes.
 A 21" p. pine bears S.67⁰W., approx. 100 ft. (fits approx. GLO location). Some evidence of old scars, but nothing reliable.
 (Cont. in block 12)

PHOTO IDENTIFICATION DATA

Photo No. _____
 Filed At. _____
 Object Ident. _____
 Ident. By _____
Signature

DESCRIBE CORNER LOCATION RELATIVE TO NEAR-BY FEATURES, ALSO HOW TO REACH CORNER

System road 690 ft. east.
 Primitive road approx. 200 ft. south.

PLANE COORDINATE POSITION DATA

State _____ Zone _____
 X _____
 Y _____
 Estab. By _____
Agency

Signature
 T, Hollamon

Title
 Eng, Tech,

Division

Headquarters
 S, O,

Date
 5/16/74

7100-52-(3/68)

CORNER RECORD (PERPETUATION)

MONUMENT: DESCRIBE NEW MONUMENT SET, OR WORK DONE TO PRESERVE EXISTING MONUMENT

ACCESSORIES : DESCRIBE NEW BT'S WITNESS OBJECTS ETC. ESTABLISHED, OR WORK DONE TO PRESERVE EXISTING EVIDENCE

I placed blank B.T. tag on only known B.T. (NE quadrant).

Work Done By _____ Title _____ Date _____ State Registration No. or Agency _____

Certified Cor. Record Prepared? Yes No Filed At: _____ Date _____

REMARKS

(Block 3 cont.)

No evidence of B.T. in SE quadrant.

Section line marker board and old location poster on 36" p.pine on west edge of road 690 ft. east of corner. (Road between Log Springs and Gurdane.) (Board set on north-south line, corner is west.)

Index File No. T. R. M. Tract or Surv. No. Cor.