

CERTIFIED RECORD OF LAND CORNER MONUMENTATION

History of original corner establishment:

Corner established in 1882 by George S. Pershin under General Land Office Contract No. 430.

Surveyor General's records state:

Set a basalt stone 15x10x7 ins. 10 ins. in ground on West slope for 1/4 Sec. Cor. marked 1/4 on N face.

A pine 42 ins. di brs. North 24 lks. dist. marked 1/4 S BT.

A pine 48 ins. di. brs. S34°E 56 lks. dist. marked 1/4 S BT.

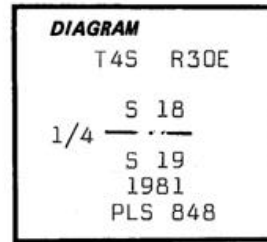

N-3

Description of corner evidence found:

Found broken 11x10x7 in. stone with 1/4 clearly visible.

From which

Found pine 42 in. dia., dead, down and rotten. Blaze and axe marks visible, bears approx. North 16 ft.

Found pine 50 in. dia., dead, down and rotten. Bears approx. S35°E, 38.0 ft. No marks visible.

Accepted stone as 1/4 corner position.

Description of monument and accessories I established to perpetuate the original location of this corner:

Set 3"x30" galv. iron pipe with 3" brass cap stamped as shown on the diagram, set 16 inches in the ground and placed a ring of stone around the pipe.

Placed original stone North alongside pipe.

From which

A fir 15 inches dia. bears S3°E, 5.7 ft. scribed 1/4 S 19 BT.

A fir 18 inches dia. bears N38°E, 10.5 ft. scribed 1/4 S 18 BT.

Set steel posts with warning and boundary signs 5 ft. East and 5 ft. West from corner.

Nailed bearing tree signs and brass washers stamped PLS 848 to each tree. Painted red band around each tree.

I hereby certify that the above corner monument was reestablished as herein described, on 9/81.

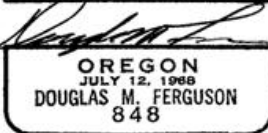
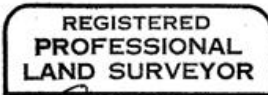

Witnesses to above corner:

D. Mitchell Ferguson

Mike Woodward

Office of... Co. Surveyor... County of... Umatilla... Oregon... I hereby certify that the within instrument was filed in this office for record on the... 27th day of... January... 1982... David... (COUNTY OFFICIAL)... by... Betty... (DEPUTY)

82-2-6

T-1