

Index File No. N-19  
 T 4 S.      R. 30 E.       
 Merid. Willamette

**CORNER RECORD (SEARCH)**

(Ref. FSM 7151.4)

Tract or Survey No.                      Cor. No.               
 R.D. Ukiah County Umatilla  
 N.F. Umatilla State Oregon

**CORNER DIAGRAM**

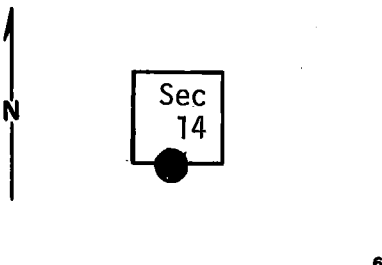

**DESCRIBE CORNER MONUMENT FOUND**

Basalt stone, 12"x10"x8", 6" above ground, fair condition. Cannot distinguish marking. Stone sets in circle of smaller stones.

*monumented by BLM, 1978*

**DESCRIBE BEARING TREES OR OTHER OFFICIAL ACCESSORIES FOUND**

A 26" p. pine bears S.50°E., approx. 48 ft. (GLO says S.40°E., 72 links). Marks which appear to be scribing are visible through a small opening which faces stone mound. This tree has an old location poster.

There is also an old location poster on a 13" p. pine which bears N.60°E. Approx. 12'. However, the poster and an old blaze face the B.T.

**DESCRIBE CORNER LOCATION RELATIVE TO NEAR-BY FEATURES, ALSO HOW TO REACH CORNER**

Mound sets on east facing slope near top of east sloping hog-back. Semi-open area with scattered second growth p.pine (with a few scattered mature p. pine)  
 It is approx. 500 ft. west of a primitive road.

**PHOTO IDENTIFICATION DATA**

Photo No.                       
 Filed At.                       
 Object Ident.                       
 Ident. By                       
*Signature*

**PLANE COORDINATE POSITION DATA**

State              Zone               
 X                       
 Y                       
 Estab. By                       
*Agency*

Signature	Title	Division	Headquarters	Date	7100-52-(3/68)
T, Hollamon	Eng, Tech,		S, O,	5/17/74	

CORNER RECORD (PERPETUATION)

MONUMENT: DESCRIBE NEW MONUMENT SET, OR WORK DONE TO PRESERVE EXISTING MONUMENT

ACCESSORIES : DESCRIBE NEW BT'S WITNESS OBJECTS ETC. ESTABLISHED, OR WORK DONE TO PRESERVE EXISTING EVIDENCE

I placed a blank B.T. tag on the assumed B.T.

I also placed a location poster on a 9" p. pine approx. 500' east (20 ft. west of old road)

Work Done By \_\_\_\_\_ Title \_\_\_\_\_ Date \_\_\_\_\_ State Registration No. or Agency \_\_\_\_\_

Certified Cor. Record Prepared ? Yes No Filed At: \_\_\_\_\_ Date \_\_\_\_\_

REMARKS

Index File No. T. R. M. Tract or Surv. No. Cor.